

1

- Ensure ducts are clean and dry.
- Cut the Acoustic Liner to stretch out dimensionally into the duct.

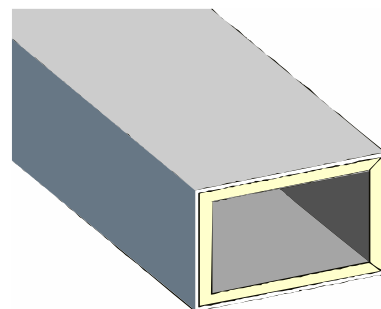

2

- Install the Acoustic Liner, tightly butted on the inside of the duct. Make sure the black woven glass is facing towards the airstream.
- Edge coat all the joints with a mastic sealant.

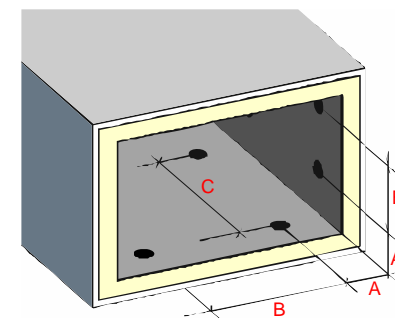

3

- Fix the Acoustic Liner to the sheet metal with mechanical fasteners, either impact driven or weld secured. This will compress the Acoustic Liner sufficiently to hold it firmly in place.
  - Air velocity up to 12.8 m/s-fasteners should not be more than 100mm from the corners of the duct, not more than 300mm centres across the width and not more than 450mm centres along the length.
  - Air velocity from 12.8 m/s to 20m/s -fasteners should not be more than 100mm from the corners of the duct, not more than 150mm centres across the width and not more than 400mm centres along the length.
- See table below:
- | Air Velocity (m/s) |        |         |
|--------------------|--------|---------|
|                    | 0-12.8 | 12.8-20 |
| <b>A</b>           | 100    | 100     |
| <b>B</b>           | 300    | 150     |
| <b>C</b>           | 450    | 400     |

**TOOLS** - Specialised tools.

**HANDLING AND STORAGE** - Acoustic Liner must be stored flat, in dry conditions and under cover. Handle the product with care and take special care of corners and edges. This product may suffer permanent damage from excessive pressure such as sitting or standing on the product.