



Fixed Bollard

Product Description:

ALLTECH's sure stop Bollard is designed for simple and quick installation and is constructed to withstand harsh environmental conditions. Bollard is used for controlling access to high security areas such as police stations, banks, border posts, cash handling depots, high risk cargo depots, government buildings, airport security areas, and embassies. The bollards can also be used for standard risk areas such as car parks, toll roads, hotels, hospitals and shopping malls.

Drive:

Fixed construction

Materials

Mild Steel or Stainless Steel 304

Technical Features

- Designed for long operational life
- Provides a high degree of impact resistance and security

Power Failure

The fixed bollard is not affected by power failures

Technical Data

Dimensions: Bollard Ø220 x 600mm
 Bollard Ø220 x 800mm

Models Available

- 600mm Stainless Steel Bollard
- 800mm Mild Steel Galvanised Bollard
- 800mm Stainless Steel Bollard

Site Preparation

Product Delivered as Assembled and may require lifting equipment
(For installation details, please refer to the installation Manual)

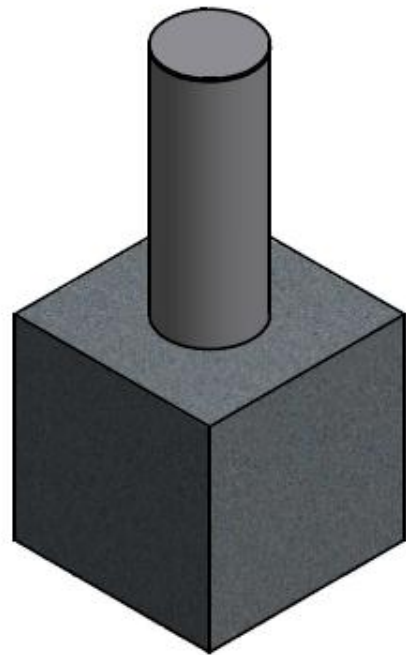
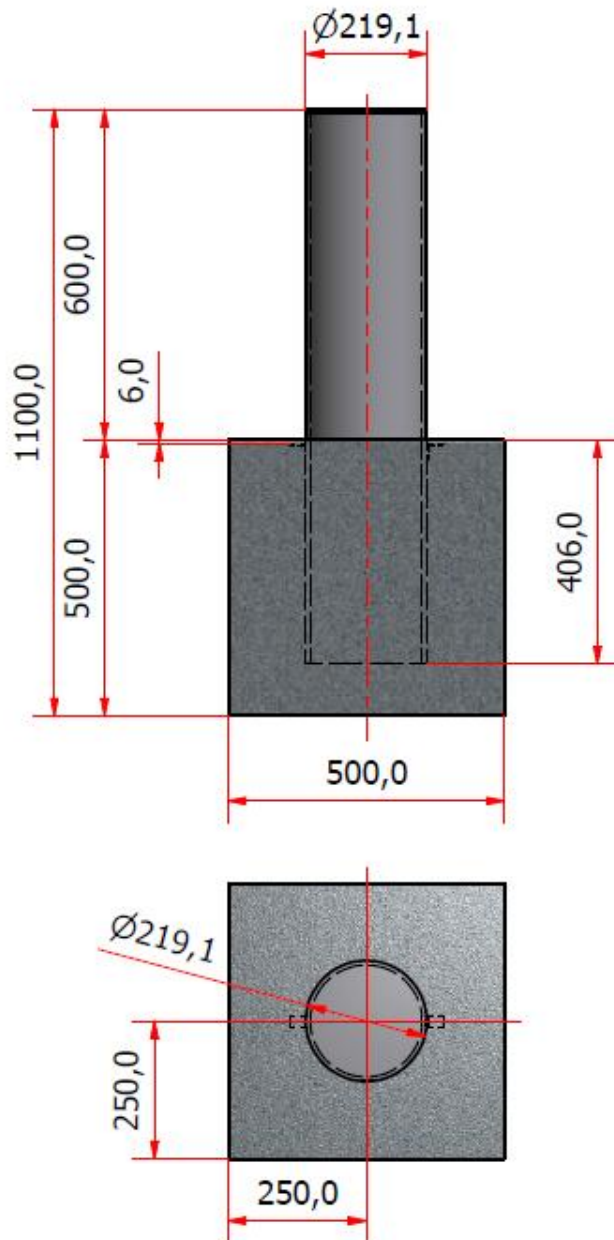

Important

- The dimensions given in this Product Data Sheet are for Information only. In order to prepare the installation site, please refer to the installation manual or ask conformation
- It is the customer's responsibility to ensure the structural integrity and strength of the installation

Concrete slab & floor site preparation

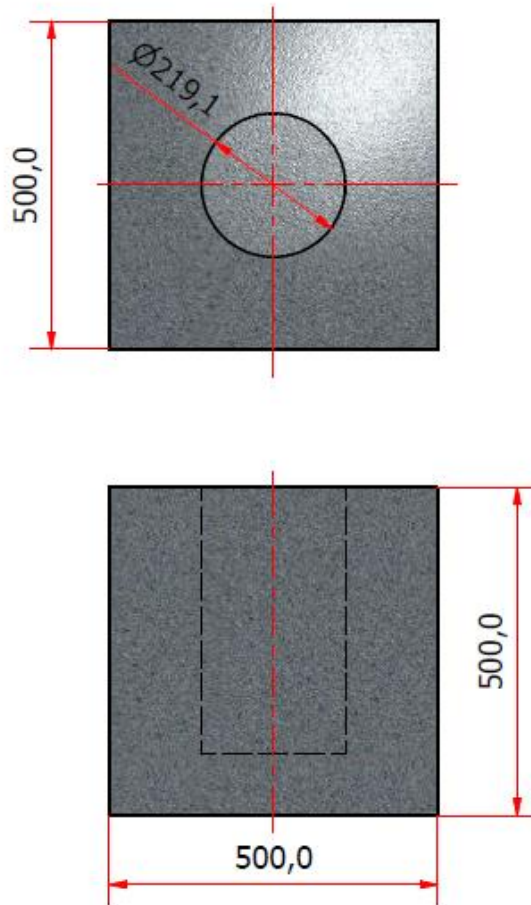

Concrete base to specification at least fck (cube) 300N/mm² of resistance
Base to be flat and level to +/- 5mm over footprint area.
Dimensions to be 500 x 500 x 500 deep min. (Units in mm)

105 Nagington Road,
Wadeville, Germiston
Private Bag X023,
Wadeville, 1422

Tel: +27 11 824 5780
Fax: +27 11 824-5766
E-Mail: info@alltechsa.com
Website: www.alltechsa.com

Co. Reg: 1999/005855/07
VAT: 4290184714
PSIRA: 0017196

Directors: A. Vermeulen (General Manager), M. Houseman**, R. Armour
** British