

1. **Main Tees:**
 - Product: Donn T38 FR QRC Main Tee.
 - Main tees shall be spaced at 1200mm centres.
2. **Cross Tees:**
 - Product: Donn QRC T38V 1200mm Cross Tee and Donn QRC T38V 600mm Cross Tee.
 - Donn QRC T38V 1200mm cross tees shall be spaced at 600mm centres.
 - Donn QRC T38V 600mm cross tees shall be clipped into the centre of the Donn QRC T38V 1200mm cross tees.
3. **Suspension:**
 - Product: Donn pre-stretched galvanised hanger wire 2.5mm or Donn Hanger strap 19mm.
 - Suspend Donn T38 FR QRC main tees using Donn pre-stretched galvanised hanger wire 2.5mm at 1200mm centres, the wire should be wound 3 times around itself at the main tee or
Donn Hanger strap 19mm at 1200mm centres, fix hangers to the main tees using 2 steel pop- rivets or 1 Gyproc Wafer head tek screw.
 - Main tee to be suitably fixed to the wall using “angle cleats”.
 - Donn pre-stretched galvanised hanger wire 2.5mm or Donn Hanger strap 19mm shall be suitably suspended from structural members of the building.
 - Install Donn QRC T38V 1200mm cross tees at 600mm centres and clip-in Donn QRC T38V 600mm cross tees at the centre of the Donn QRC T38V 1200mm cross tees.
5. **Wall Angle:**
 - Product: Donn SM25 or Donn M6 wall angle.
 - Fix wall angle to the wall using fixings at 300mm centres.
 - Fix Donn T38 FR QRC main tees to the perimeter angle.
6. **Ceiling Tile:**
 - Product: “Celotex Pin Perforated mineral fibre tiles”.
 - Size: 595 x595mm.
 - Thickness: 15mm
 - NRC: 0.55
7. **Accessories:**
 - Product: Hold down clips, in areas susceptible to draught.
 - Hold down clips shall be installed on the ceiling. 2 per Cross Tee.

8. Insulation

- Where required, for improved thermal and acoustic performance, lay Isover insulation onto the ceiling.
- Thickness= 100mm/115mm/135mm (according to climatic zone, see table below.)

SANS 10400XA and SANS 204 requirements for ceiling insulation.

Climatic zone	1	2	3	4	5	6
Isover Aerolite thickness (mm)	135	115	100	135	100	135
R-value of Aerolite	3.38	2.88	2.5	3.38	2.5	3.38
Min. required total R-value	3.7	3.2	2.7	3.7	2.7	3.5

NB-To be read in conjunction with Lay-in Grid Finishing and Fixings document and General Ceiling Design Guidelines document.

Grid Layout

Cross tees more than 600mm should be suspended at 400mm from the wall.

Donn SM25 shadow line wall angle or M6 wall angle fixed to the wall at 300mm centres or

Ceiling tile on Donn Tee system

Main tees suspension should not be more than 400mm from the wall and at 1200mm centres thereafter

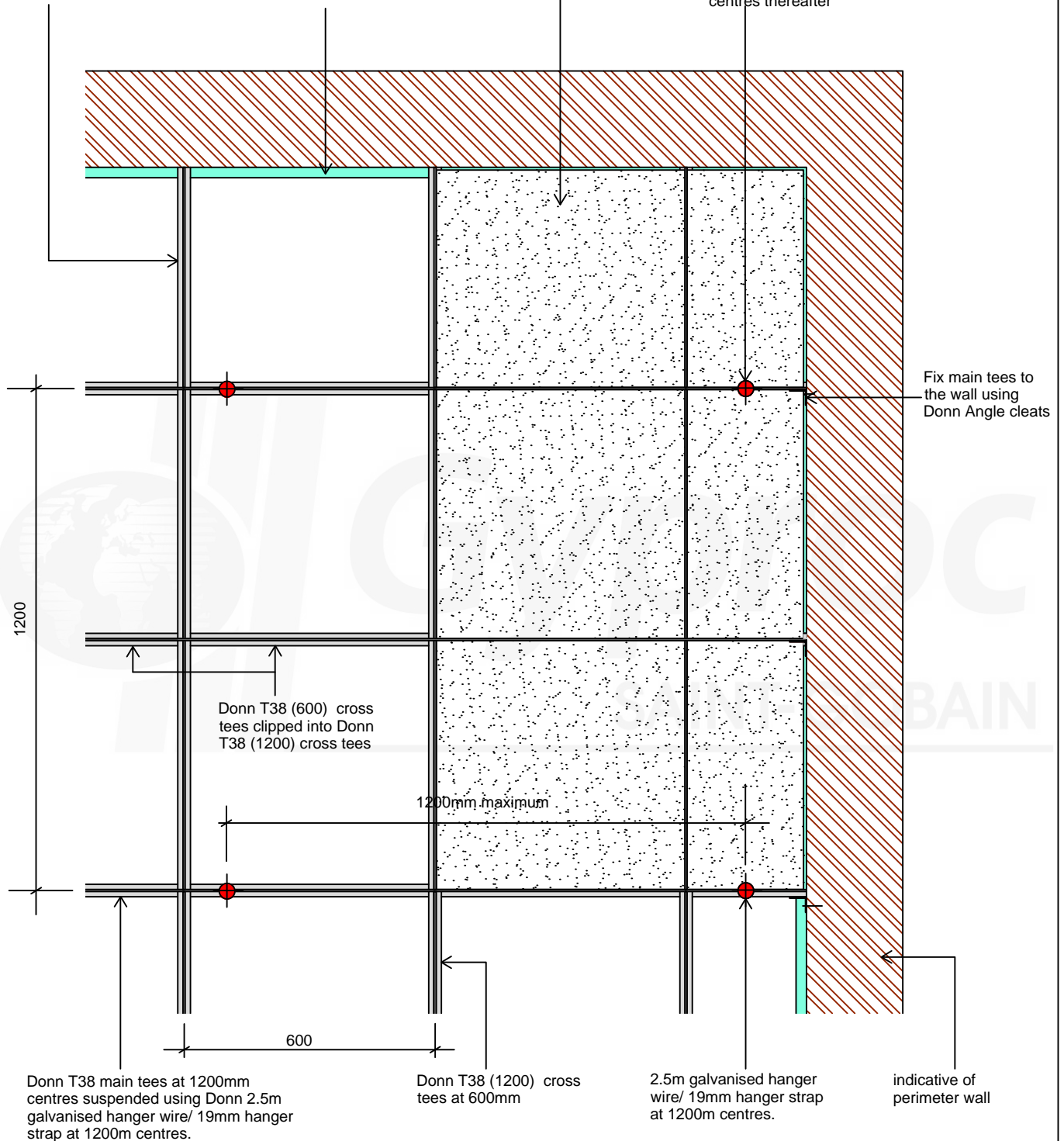

details shown are subject to accuracy of information provided to Saint-Gobain Construction Products at the time the drawings was originally requested. No duty of care is owed to the recipient or any other third party and Saint-Gobain Construction Products does not accept any liability in respect of details shown. This Saint-Gobain Construction Products System Detail must not be used without a complete evaluation by owner's design professional to verify the suitability of its use with your specific application. The detail should be read in conjunction with Saint-Gobain Construction Products current literature available on www.gyproc.co.za

DRAWING NO.

DC-600(T38)GRID_LAYOUT-2

NOTES

To be read in conjunction with project specifications

SCALE

not to scale

Light Fixture Suspension

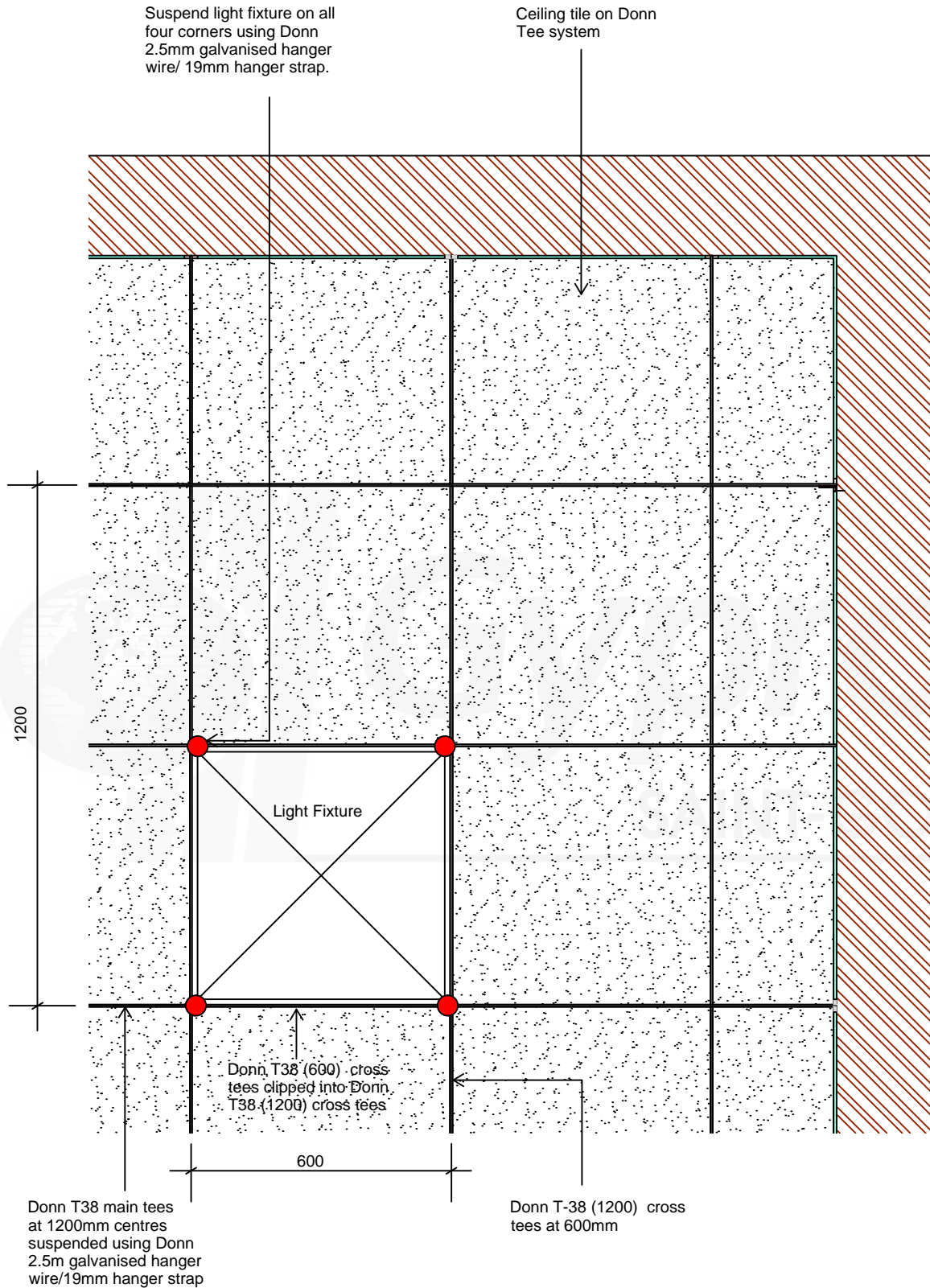

details shown are subject to accuracy of information provided to Saint-Gobain Construction Products at the time the drawings was originally requested. No duty of care is owed to the recipient or any other third party and Saint-Gobain Construction Products does not accept any liability in respect of details shown. This Saint-Gobain Construction Products System Detail must not be used without a complete evaluation by owner's design professional to verify the suitability of its use with your specific application. The detail should be read in conjunction with Saint-Gobain Construction Products current literature available on www.gyproc.co.za

DRAWING NO.	DC-600GRID_LIGHT_FIXTURE-1	
NOTES	To be read in conjunction with project specifications	
SCALE	not to scale	

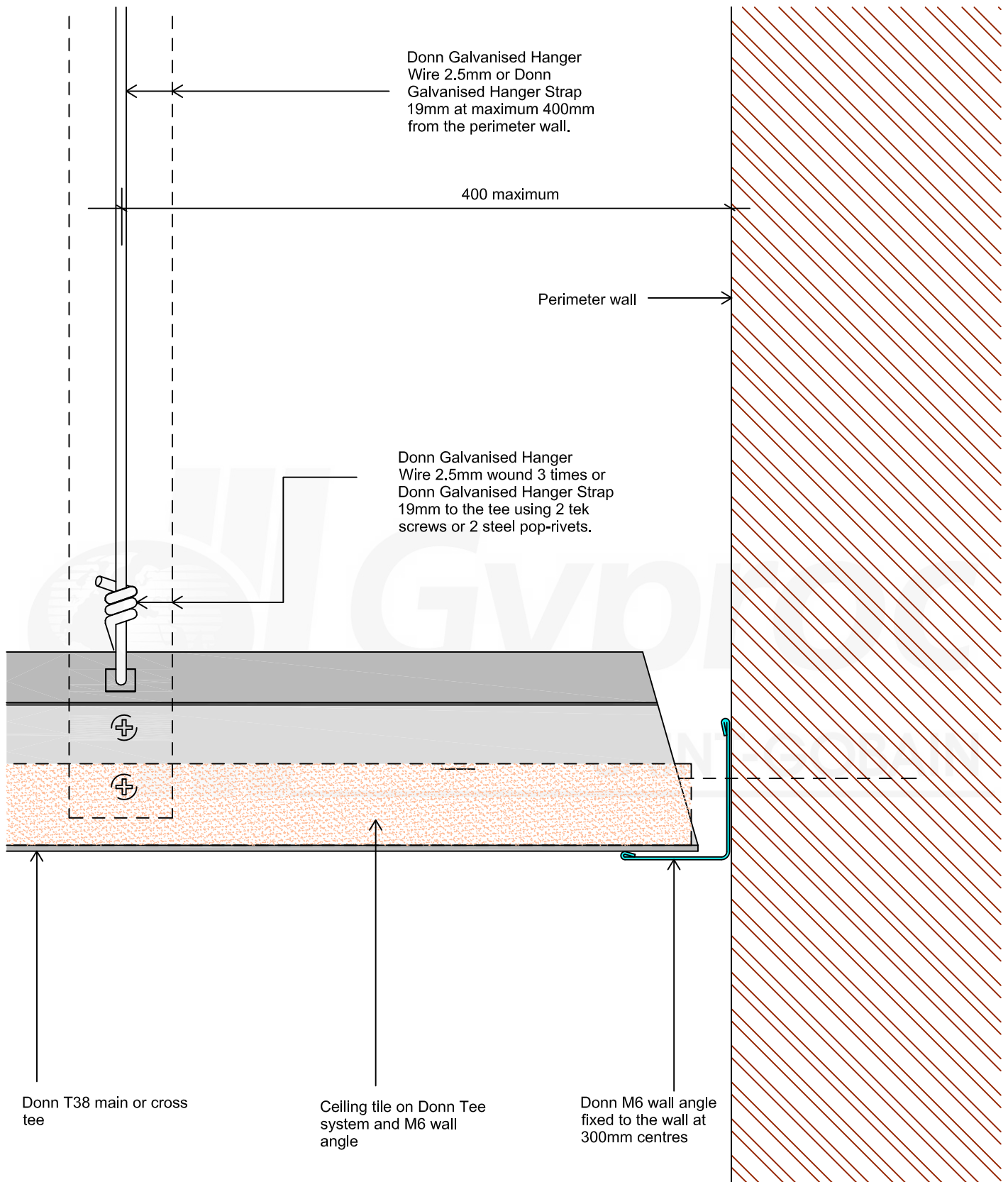

Details shown are subject to accuracy of information provided to Saint-Gobain at the time the drawings was originally requested.
No duty of care is owed to the recipient or any other third party and Saint-Gobain does not accept any liability in respect of details shown.
This Saint-Gobain System Detail must not be used without a complete evaluation by owner's design professional to verify the suitability of its use with your specific application.
The detail should be read in conjunction with Saint-Gobain current literature available on www.gyproc.co.za.

DRAWING NO.

DC-M6_PERIM-2

NOTES

To be read in conjunction with project specifications

SCALE

not to scale

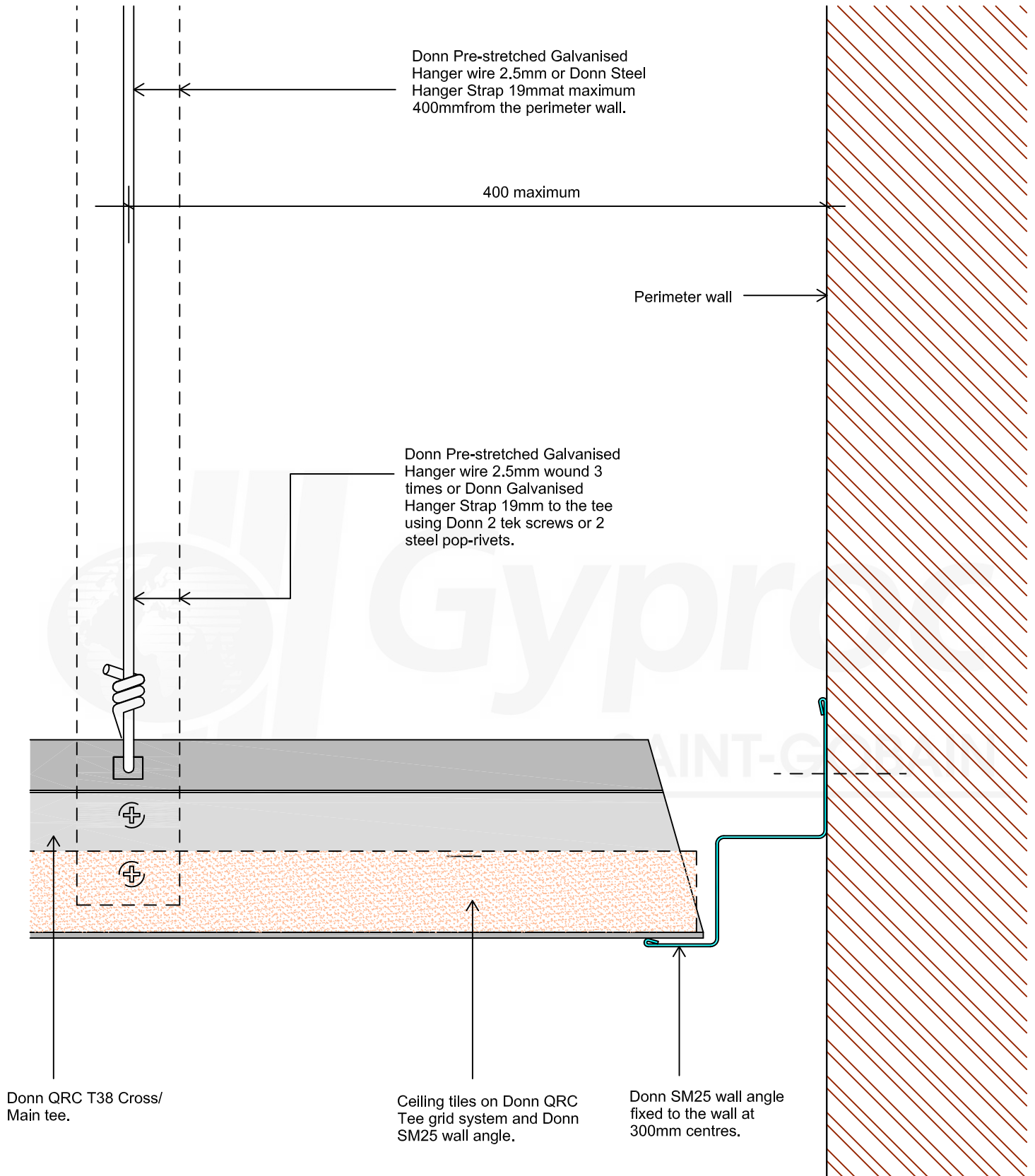

Details shown are subject to accuracy of information provided to Saint-Gobain at the time the drawings was originally requested.
No duty of care is owed to the recipient or any other third party and Saint-Gobain does not accept any liability in respect of details shown.
This Saint-Gobain System Detail must not be used without a complete evaluation by owner's design professional to verify the suitability of its use with your specific application.
The detail should be read in conjunction with Saint-Gobain current literature available on www.gyproc.co.za.

DRAWING NO.

DC-SM25_PERIM-2

NOTES

To be read in conjunction with project specifications

SCALE

not to scale