

Siniat System Summary



Siniat Firecheck Wall 64/F120 A59 GW51mm

Components	System weight (kg/m ²)	Max height (m)	Overall Thickness (mm)	Fire perf (mins)	Acoustic Perf. (R _w -dB)
<ul style="list-style-type: none"> • 2x15mm Siniat Firecheck T/E Plasterboard • 64mm Drywall steel stud • 65mm Drywall steel track • 14-18kg/m³ glasswool • Siniat Drywall jointing compound • 25mm and 41mm Drywall Screws • Floor and ceiling finishes as per specification 	54	3.6	124	120	59

Specifications

Siniat Fixed Partition: 124mm

Supply and install Siniat Fixed Partition from Siniat drywall partitioning system with an overall thickness of 124mm comprising internal framing formed of 64mm Siniat galvanised steel studs fixed at 600mm centers to Siniat galvanised steel top track positioned at floor, head and install glasswool in the metal frame cavities.

The internal steel framing is to be dressed on both sides with two layers of 15mm thick Siniat Firecheck Plasterboard, stagger fixed, in single layer to suit height, butt jointed and secured to steel stud with 25mm drywall screws at maximum 220mm centers (first layer) and 41mm drywall screws (second layer). Joints are to be taped and jointed with Siniat Jointing Compound and Siniat fibatape and prepared for painting.

All external aluminium door frames, glazing frames, ceiling and wall channels and skirting are to be formed of natural anodized / colour anodized / powder coated to specific colour.

Maximum Height: 3600mm

Installation to be in accordance with SABISA (South African Building Interior Systems Association) installation guidelines.

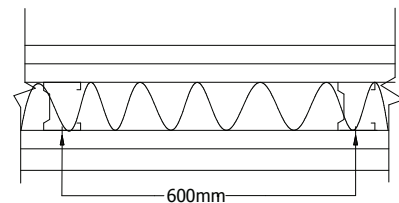
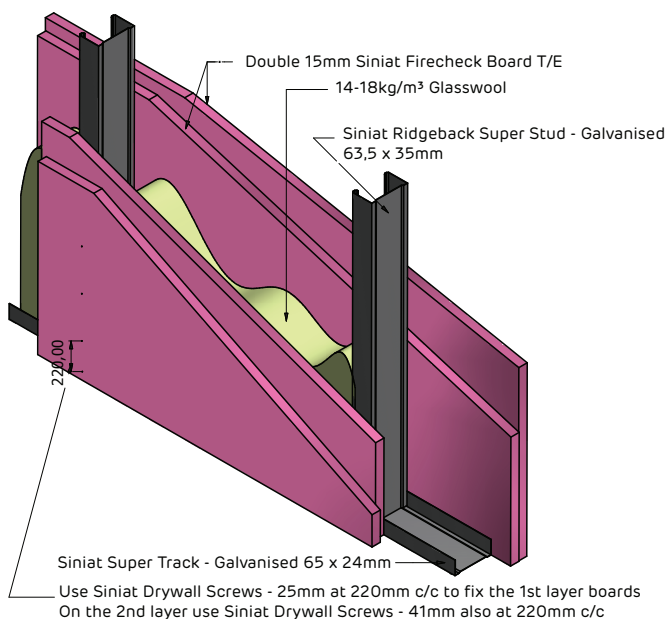

Tel: (+27 11) 389 4500

Email: contactus.mbs@etexgroup.com

www.marleybuildingsystems.co.za