

Engineering quiet since 1973





Variflex® mobile acoustic partitioning
(pages 3 to 14)



Varikust® acoustic doors
Glass, utility, elephant and acoustic FIRE doors
(pages 15 to 22)



Absorption panels
Slotted wood veneer absorption panels
Fabricmate absorption panels
(pages 23 to 26)



GF Serene acoustic glass partitions
(pages 27 to 28)



Sunflex frameless glass enclosures
(pages 29 to 30)



Solux® technical sun control
(pages 31 to 32)



Solamark® sun control awnings
(pages 33 to 34)



Showerflex® shower enclosures
(pages 35 to 36)



Varifold® non-acoustic wooden folding doors
(pages 37 to 38)



Glass bricks
(pages 39 to 40)





VARIFLEX[®]

mobile acoustic partitions

ENGINEERING QUIET



Overview

Acoustics

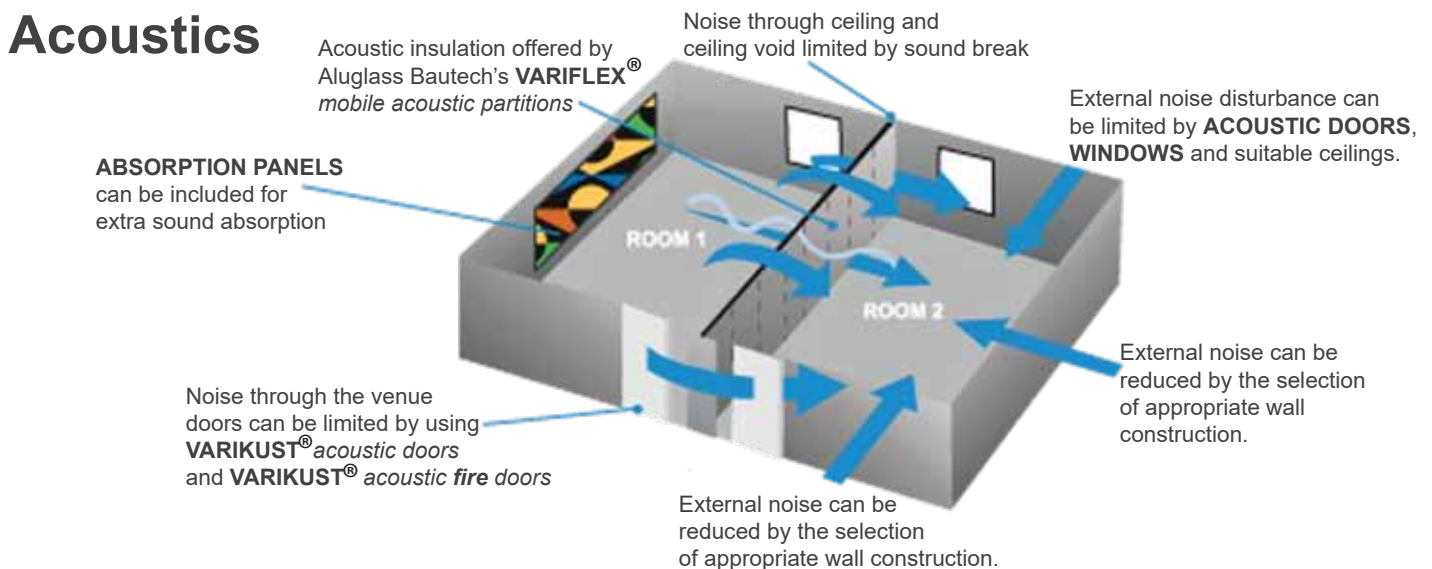

Acoustic rating selection table

		louder				
Room 2	Room 1					
	Activity	Meeting 50dB (BN) 75dB (Peak)	Discussion 50dB (BN) 80dB (Peak)	Conference 50dB (BN) 85dB (Peak)	Audiovisual (AV) presentation 50dB (BN) 90dB (Peak)	Studio Recording 35dB (BN) 85dB (Peak)
louder	Meeting	40dB	45dB	49dB	≥ 49dB	52dB
	Discussion	45dB	45dB	49dB	≥ 49dB	52dB
	Conference	49dB	49dB	49dB	≥ 49dB	n/a
	AV presentation	≥ 49dB	≥ 49dB	≥ 49dB	45dB	55dB
	Studio recording	52dB	52dB	n/a	55dB	55dB

Which Variflex® system to use?

System	Acoustic rating	Max height (mm)
VX83	40dB	4800
	45dB	4800
	49dB	4200
VX110	47dB	7000
	50dB	7000
	52dB	6000
VX164	52dB	12000
	55dB	10000

The updated acoustic sound level testing method is an in-situ measurement of the Standardised Level Difference according to ISO 162283-1 2014, analysed according to weighted Standardised Level Difference, DnTw, according to ISO 717-1.

dB	what can be heard through the partition?
30	normal speech can be perceived easily
34	loud speech can be perceived easily
40	loud speech can be perceived, but not understood
45	loud speech can be perceived only as a murmur
49	must strain to perceive loud speech
52	only some loud speech can be barely perceived
55	loud speech cannot be perceived

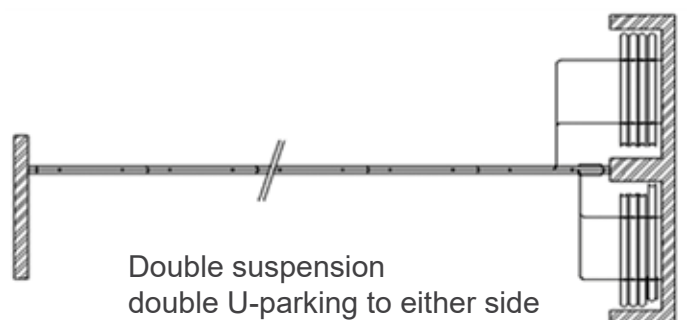
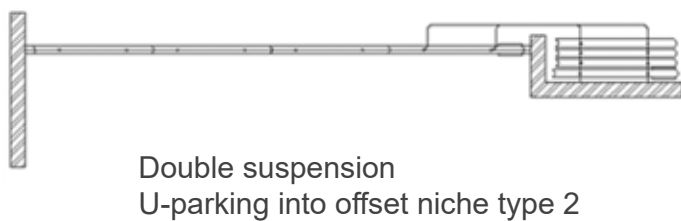
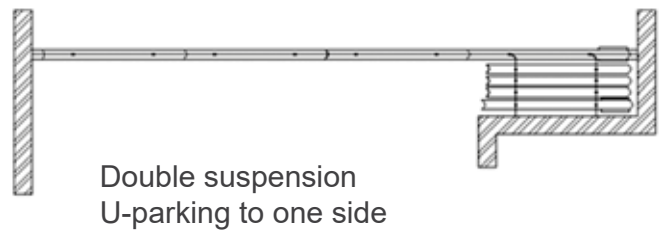
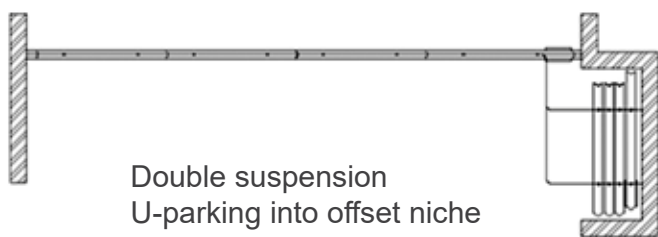
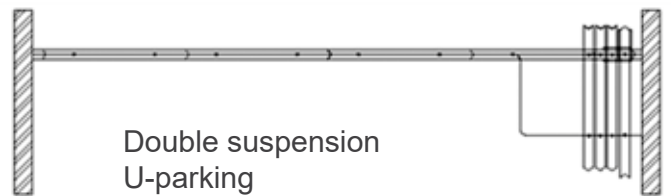
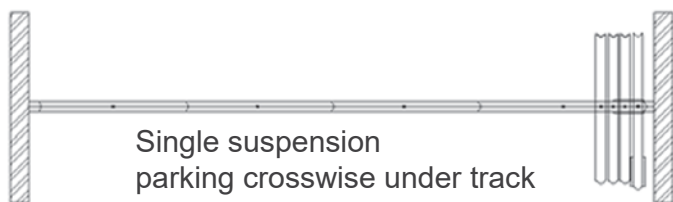

Element details

The inside of an element

1. Horizontal seal

To achieve optimum sound attenuation, a double-shell construction is used. Working on the jack principle, telescopic, flexible, spring-loaded double seals press against the ceiling track and floor; the spring sections taking up any normal ceiling deflection. Each panel exerts a load of 80–150kp (kilo pond) on the floor screed, which is not sufficient to overload the floor (particularly when the panels are parked) but is sufficient to give the Variflex system enough stability to avoid its displacement, even when subjected to pressure.

2. Corner block

Special corner sections act as corner seals and serve to increase the stability of the wall.

3. Vertical

A 4-way PVC lipped profile based on a tongue and groove principle ensures good sealing against sound penetration.

4. Magnetic strip

A 4-pole magnetic edge strip bonds adjacent elements with a force of 7kp (kilo pond) per linear meter. The modules are aligned by the magnetic strips.

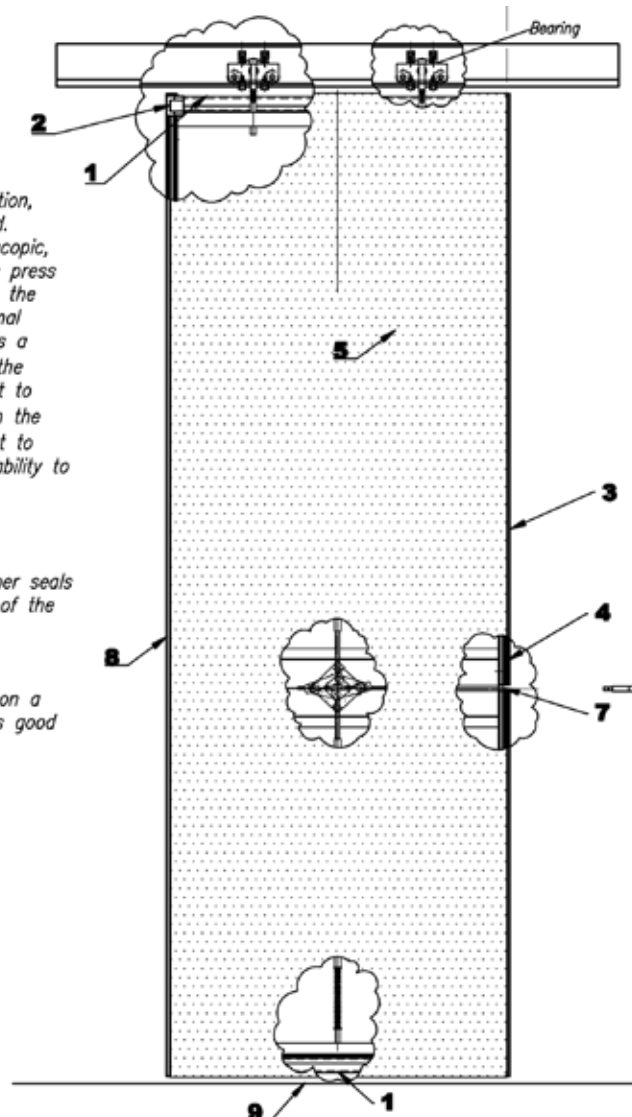

5. Facing panels

To achieve optimum sound attenuation, 16mm thick chipboard facing panels with a variety of limp mass laminates attached to the inside face of the panels, to suit the acoustic requirements, are suspended on each of the frames. These are acoustically decoupled to allow the panels to vibrate independently. Panels can be covered in a wide variety of wall finishes from natural timber veneers, wall papers, laminate surfaces etc., and individual facing panels can be interchanged. Decorative and fire retardant or non-combustible panels to various standards are available upon request, subject to confirmation.

6. Operating handle

Operating the Variflex system is carried out using a special crank handle.

7. Releasing of the Elements

The magnetic force which bonds adjacent panels together can be broken by a gentle pulling motion.

8. Frames

The element framework is made up of aluminium hollow sections and steel tube profiles. The rigid, non-deflecting framework, together with the 16mm chipboard facing panels, gives a module of high strength, exceptional sound attenuation and trouble free operation.

9. No floor guides are required.

Wall and element connection

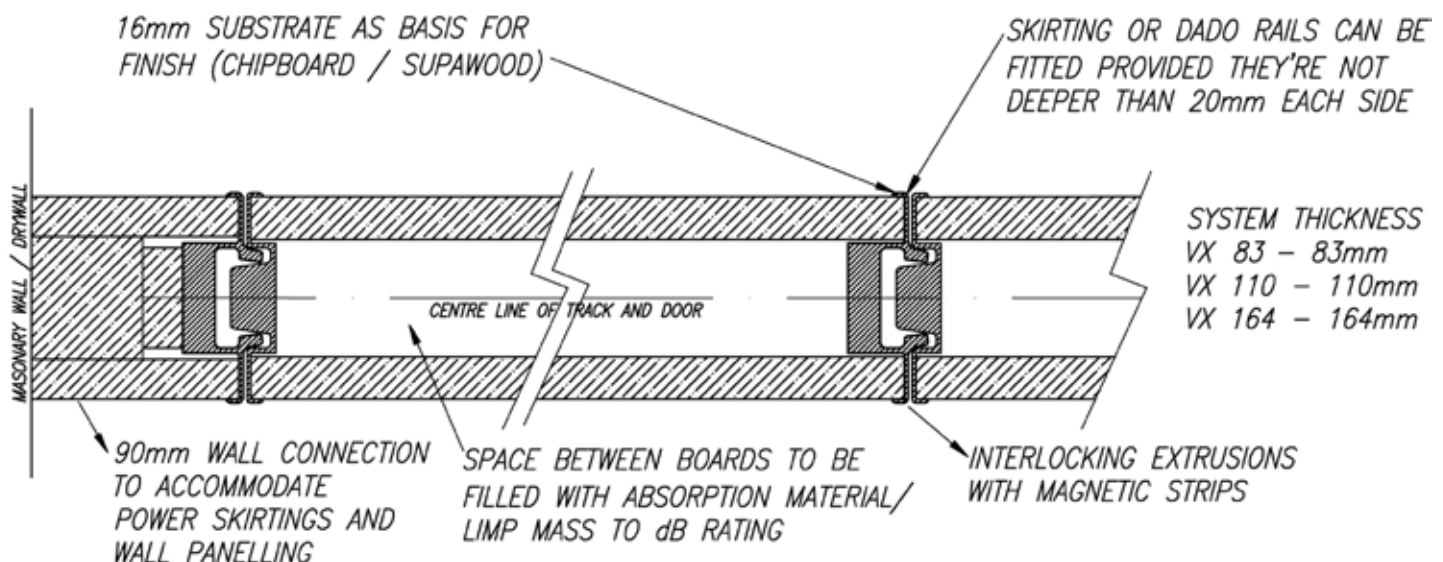

Sound test

Sound test example conducted on an in-situ product after installation

STANDARDISED LEVEL DIFFERENCE ACCORDING TO ISO 162283-1 2014 FIELD MEASUREMENTS OF AIRBORNE SOUND INSULATION BETWEEN ROOMS

TEST DATE		31-08-15
PRODUCT		VX110 - 48dB
ALUGLASS ACOUSTIC RATING		48dB
PRODUCT DESCRIPTION		VX110 System with White Board
		Finish and Limp Mass Treatment
		Wall A
TEST DESCRIPTION AND COMMENT		Some Noise Transmission evident through automated sliding doors - particularly when one is open - this reduced the acoustic separation between the spaces by between 8 and 10dB.
		Within the supplied system the Telescopic remains the greatest contributor to sound transmission between the spaces.
PARTITION / DOOR AREA		29 m ²
RECEIVING ROOM VOLUME		290 m ³
SOURCE ROOM VOLUME		348 m ³
TEST EQUIPMENT USED		
Source		Pink Noise Generator / Aluglass Omni-directional Speaker
Measurement		MIC W i436 Omnidirectional Test Microphone (Class 2)
		on Iphone 5S calibrated with Quest Calibrator (Class 1)



+27 11 451-8400
mailbox@aluglass.co.za
www.aluglass.co.za

Frequency	DnT
Hz	dB
50	19.8
63	12.2
80	21.1
100	33.0
125	39.5
160	40.0
200	44.0
250	45.1
315	45.0
400	48.2
500	46.1
630	47.9
800	48.4
1000	46.4
1250	48.3
1600	52.5
2000	51.0
2500	51.2
3150	51.0
4000	51.8
5000	53.3

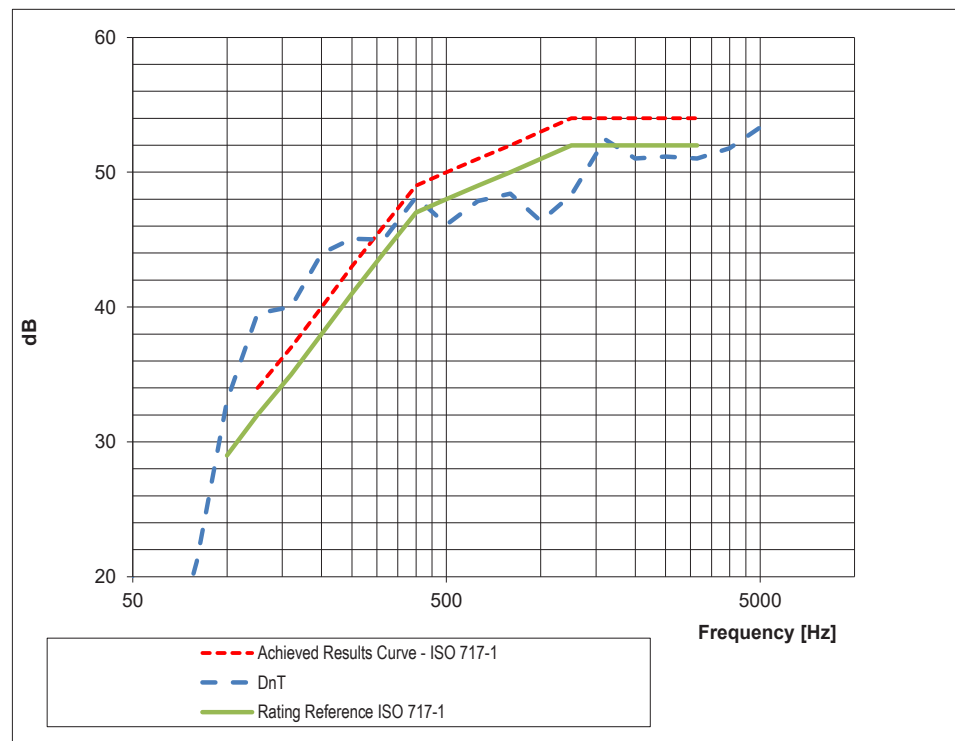

RATING ACCORDING TO ISO 717-1									
	DnT _w (C; Ctr) =			49	(0;-3) dB				
	DnT _w (C; Ctr; C ₅₀₋₅₀₀₀ ; Ctr ₅₀₋₅₀₀₀) =			49	(0;-3 -4;-15) dB				
STC RATING ACCORDING TO ASTM - E413									
				50	dB				

Acoustic test by:

Niels Eichhorn Pr.Eng.

Analysis by:

Niels Eichhorn Pr.Eng.

Layout examples

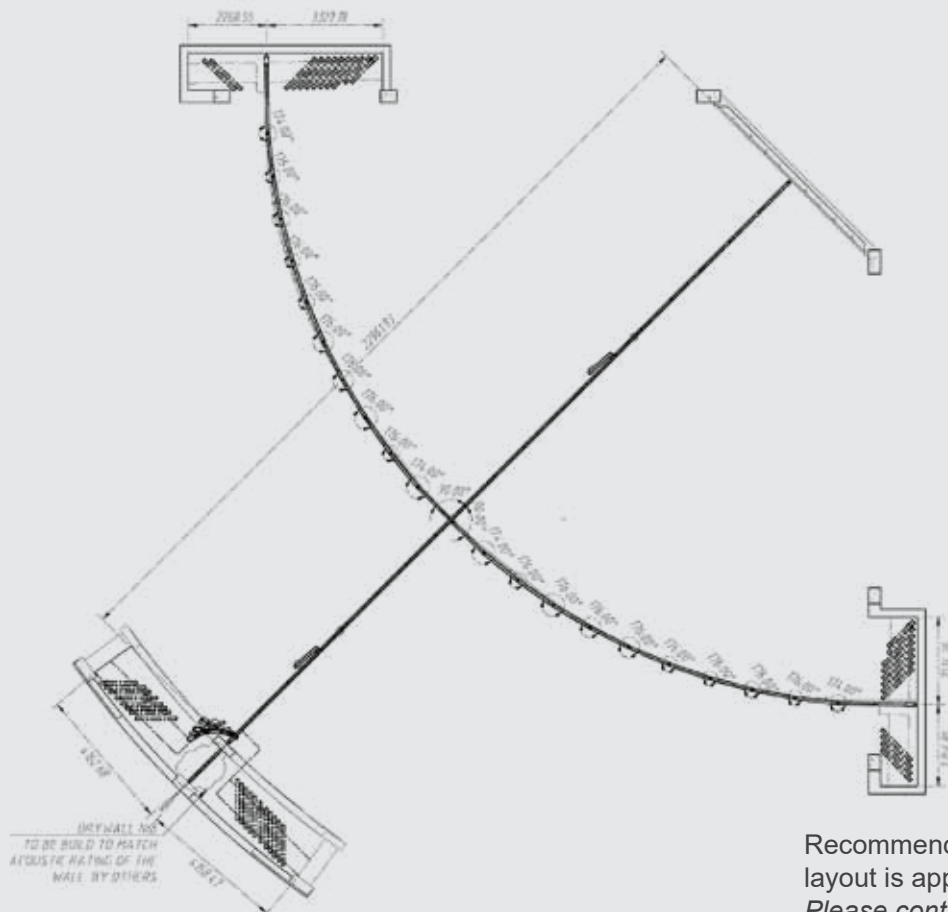
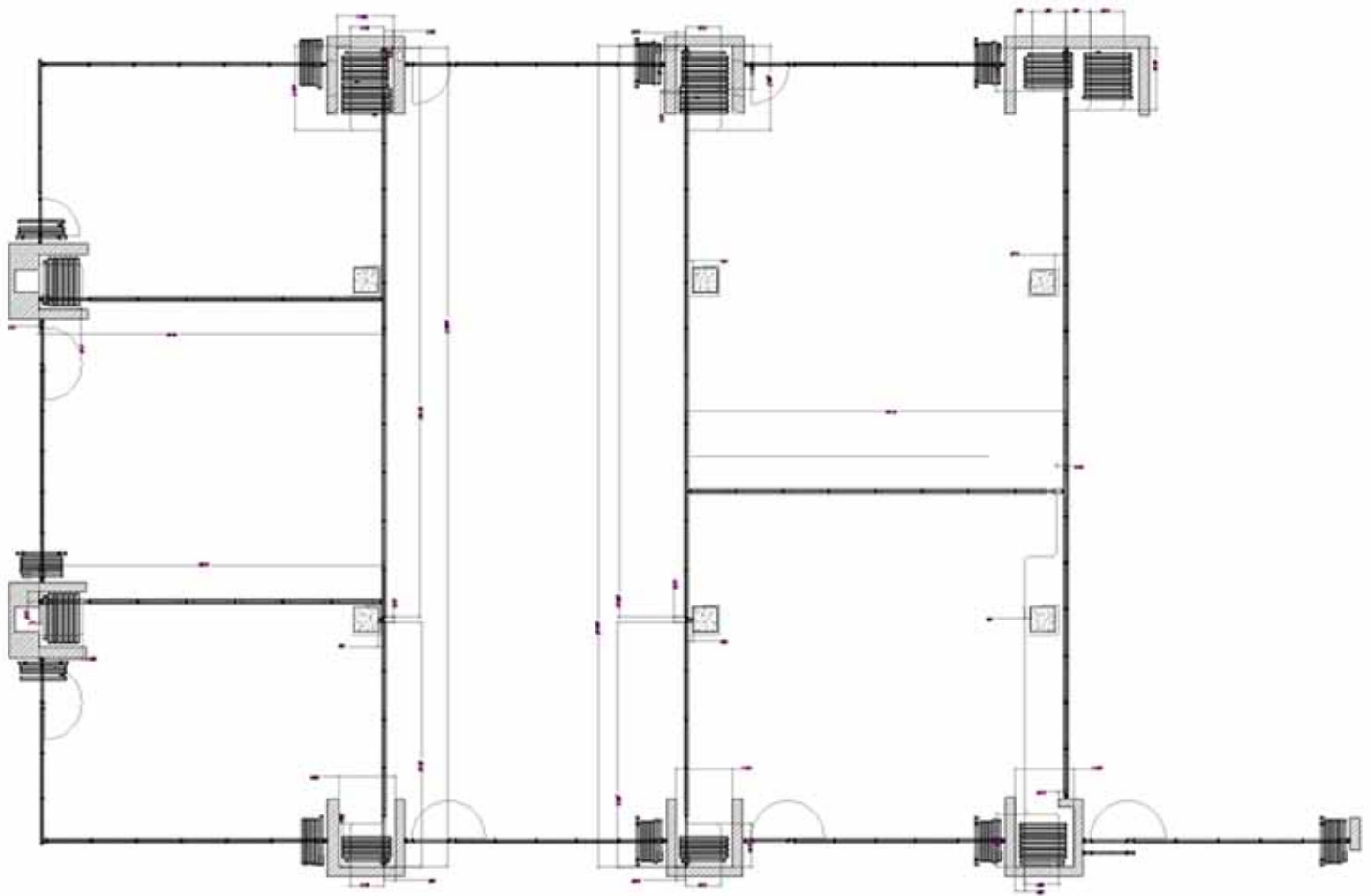

Recommended minimum radius for a curved layout is approximately 10 meters.
Please contact us for your specific requirement.

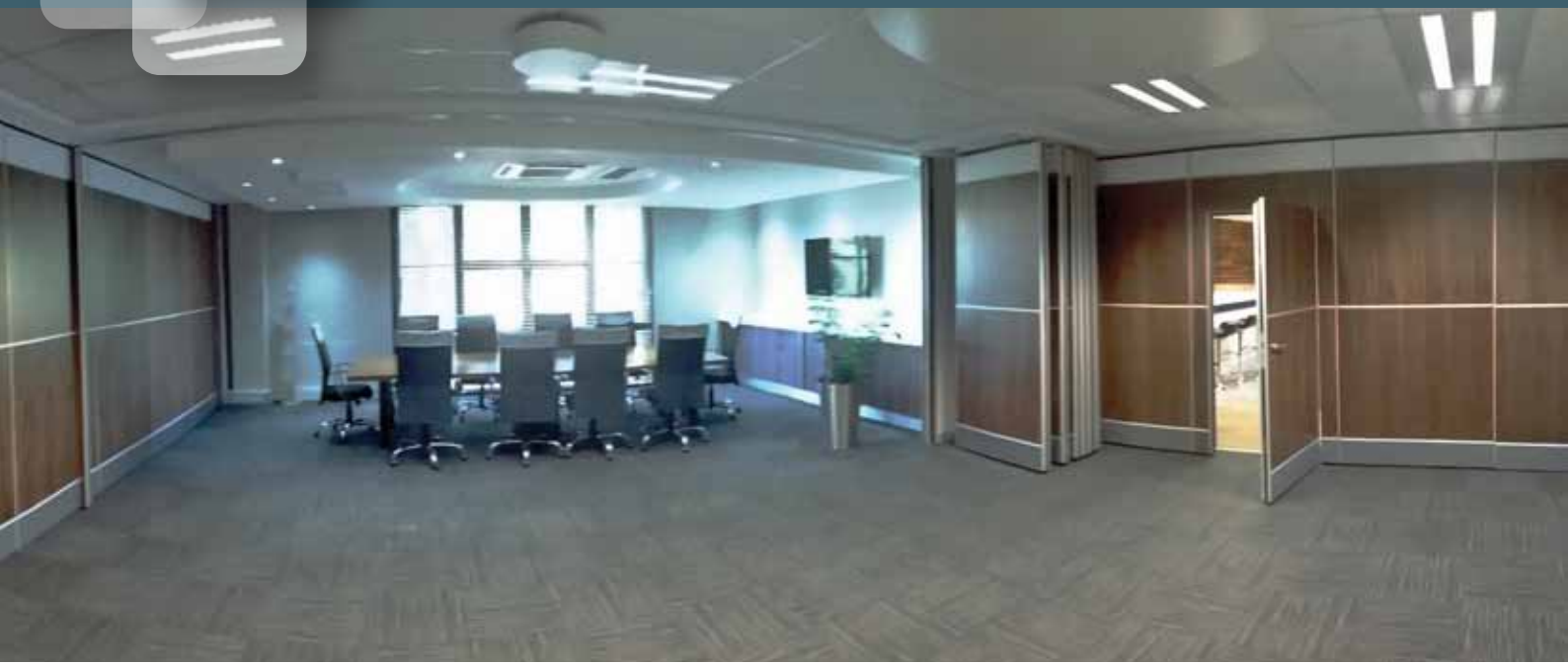

Finishes

- Fabric - any upholstery weight with a min. width of 1400mm
- Wallpaper - with a min. width of 1400mm wide
- Laminate surfaces
- Velcromat
- Glass
- MDF - sealed or painted
- Marine ply - external applications
- Natural wood veneers include:
 - Beech, Cherry, Etimoe, Kiaat, Mahogany, Maple, Oak, Rosewood, Walnut, Wenge (stains, waxes and oils can also be applied)
- Integrated magnetic white boards or pin boards
- Integrated absorption panels to assist with sound absorption

*Special requirements can be accommodated. **Please contact us for your design needs.***





Variflex® configuration comprising of standard elements and DT-pass doors within elements finished with Velcromat.

Element types

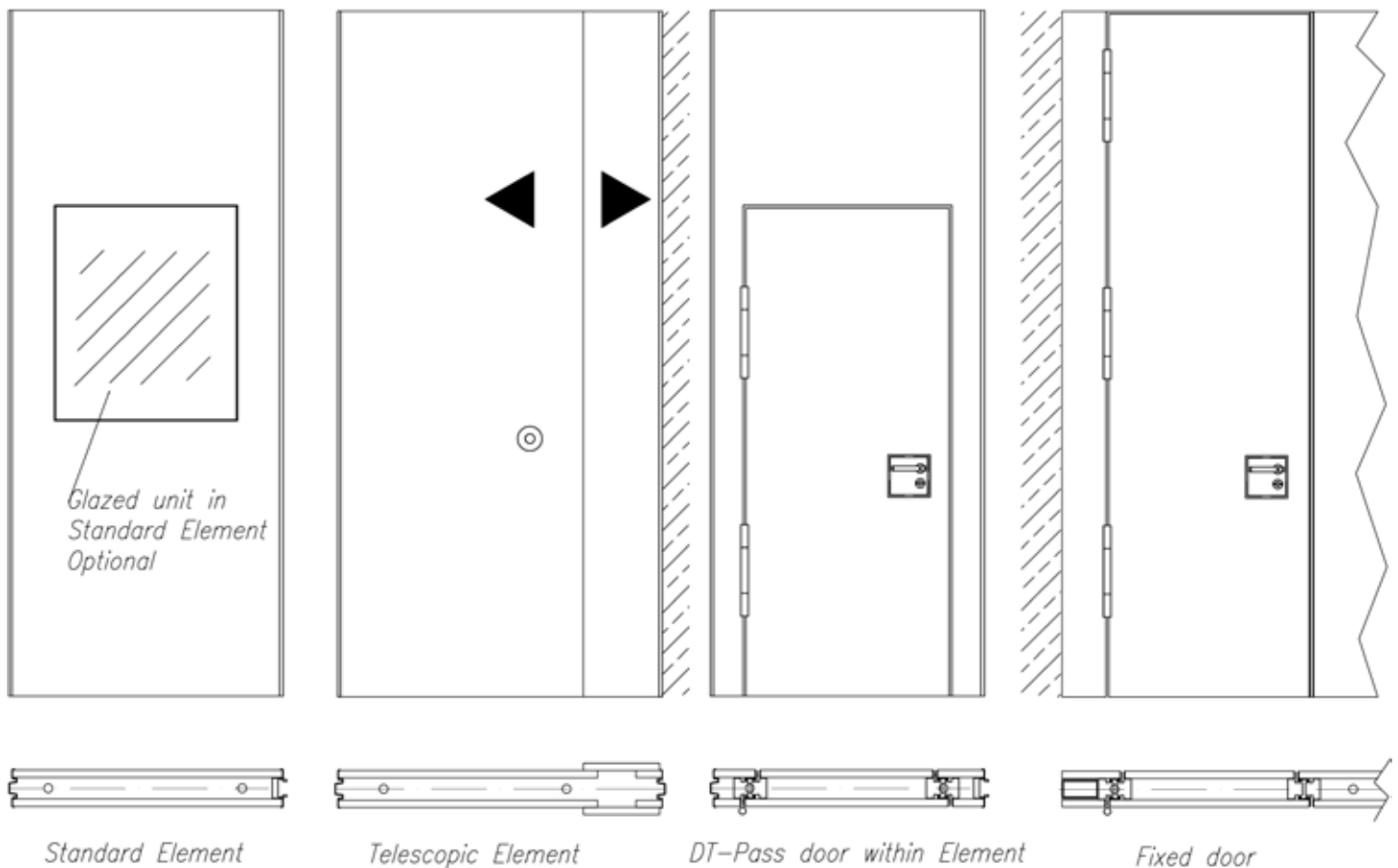

Suspension details

Concrete slab

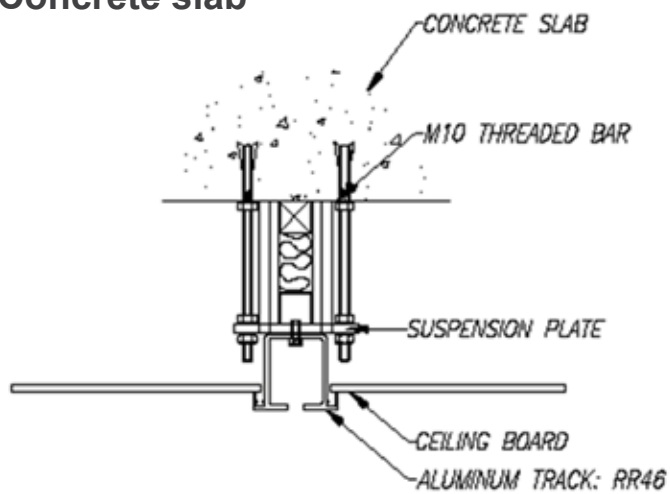

Roof trusses

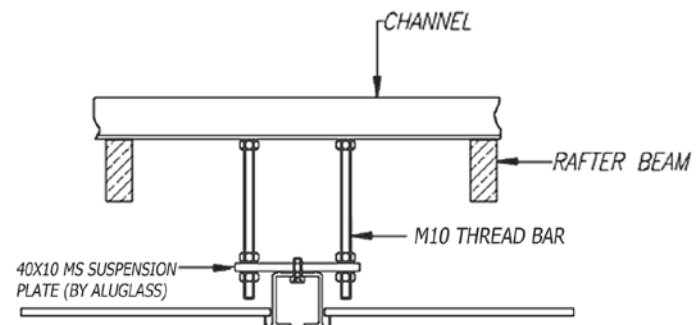

I-beam

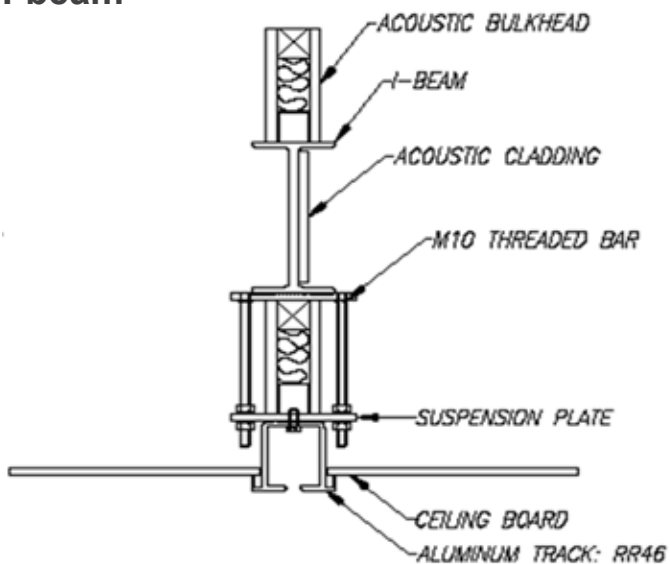

An example of a down stand beam fixing

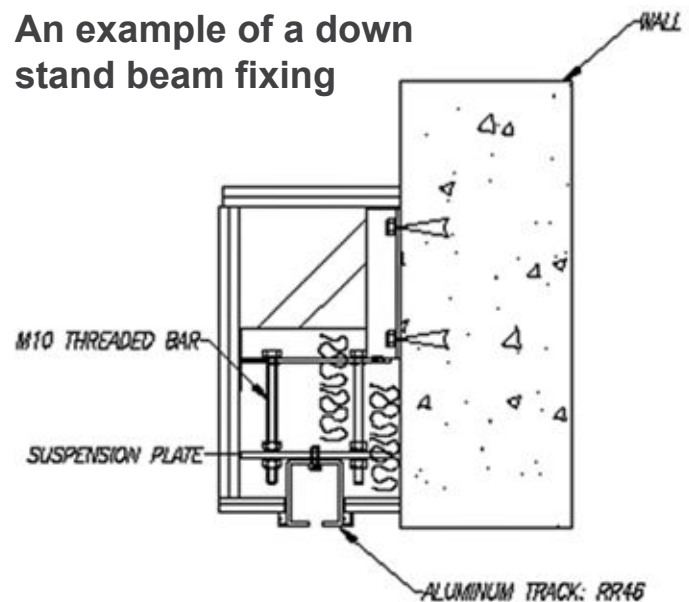



A Variflex[®] system installed at an Educational Institution, with options to have either 1 or 2 lecture rooms.



Up to 12 meters high, the Variflex[®] system is suitable for all Convention Centres providing optimal flexibility.

VARIFLEX®

mobile acoustic partitions

DESIGN FACILITIES | TECHNICAL EXPERTISE | CUSTOM MADE | PROFESSIONAL INSTALLATIONS

MAJOR PROJECTS COMPLETED

- INTERNATIONAL CONVENTION CENTRE
DURBAN PHASE 1, 2 & 3
- SANDTON CONVENTION CENTRE
- CAPE TOWN CONVENTION CENTRE
- GABORONE CONVENTION CENTRE
- EAST LONDON CONVENTION CENTRE
- MICROSOFT OFFICES

- MARRIOTT HOTEL GHANA
- SASOL
- ESKOM
- IDC AUDITORIUM
- RAND MERCHANT BANK
- SKYRINK JOHANNESBURG
- AND MANY MORE ...

FLEXIBLE & CREATIVE MULTIFUNCTION SPACE SOLUTIONS FOR

- CONFERENCE FACILITIES
- AUDITORIA
- TRAINING ROOMS
- EDUCATION FACILITIES – SCHOOLS, UNIVERSITIES, COLLEGES
- BOARDROOMS

- OFFICES
- HOSPITALS
- LABORATORIES
- PLACES OF WORSHIP
- COMMUNITY FACILITIES

SPECIFICATION TEXT

Aluglass Bautech Variflex® _____ (VX83 / VX110 / VX164) mobile acoustic (operable wall) partition, _____ mm width x _____ mm high to suit steel support up to underside of structural support (not by Aluglass Bautech) opening size _____ mm width x _____ mm high, comprising of tongued and grooved acoustically decoupled _____ dB (see 'Which Variflex system to use?' table) panels with _____ (veneer, fabric, chipcore, marine ply, supawood, wallpaper or carpet) finish, with mechanically retractable top and bottom seals and vertical seals formed of aluminium extrusions with lip seals and magnetic strips, panels suspended at (one roller trolley / two roller trolley) per panel on track with ball bearing and/or thrust rollers with track bolted to suspension plates in turn bolted to (concrete/ timber / steel) support structure and _____ mm high bulkhead fitted to and above track in ceiling void. Elements are to park (crosswise under track / U-parking) with elements stacking (one side / two sides).



SPECIFICATION TEXTS AVAILABLE ON AUTOSPEC AND OUR WEBSITE



TEL: +27 11 451 8400

FAX: +27 11 609 8097

mailbox@aluglass.co.za

www.aluglass.co.za

aluglass[®]
bautech

VARIKUST[®]

range of acoustic doors and acoustic fire doors





Varikust® product matrix

The updated acoustic sound level testing method is an in-situ measurement of the Standardised Level Difference according to ISO 162283-1 2014, analysed according to weighted Standardised Level Difference, DnTw, according to ISO 717-1.

G = glass E = elephant (huge) T = thutlwa (tall) F = fire	DnTw = 35dB to 55dB	single door (size in mm)		double door (size in mm)	
System	Acoustic rating	Max width	Max height	Max width	Max height
VK59F	38dB	900	2400		
VK62 *	35dB / 43dB	950	2750	1800	2750
VK62G	35dB / 43dB	950	2750	1600	2750
VK62F	43dB	900	2400		
VK105	45dB / 50dB / 52dB	1200	3000	2700	3000
VK105F	50dB / 52dB	1200	3000	1800	3000
VK105T	50dB / 52dB	1200	4000	2700	4000
VK105E	40dB / 45dB / 50dB			4800	5000

* In order to offer the best possible price, the VK62 is now available in 3 x standard sizes- please see below
SUPPLY ONLY - installation guide and drawings to be supplied

Standard finish - white melawood or painted melawood (additional cost will apply)

VK62 - Standard Single Door size (w x h) (mm)	VK62 - Standard Double Door size (w x h) (mm)
900 x 2100	1600 x 2100
900 x 2400	1600 x 2400
900 x 2700	1600 x 2700

NB! All other sizes for a VK62 would be quoted as 'custom' and a surcharge will apply!



SPECIFICATION TEXTS AVAILABLE ON AUTOSPEC AND OUR WEBSITE



TEL: +27 11 451 8400

FAX: +27 11 609 8097

mailbox@aluglass.co.za

www.aluglass.co.za

VARIKUST[®] VK47

***THE MOST COST EFFECTIVE ACOUSTIC DOOR
with a retractable threshold seal &
engineered timber frame***



Technical summary

47mm thick acoustic
single door set - frame,
door leaf, threshold and
ironmongery included

Maximum door size:
900mm wide x
2400mm high

Acoustic rating:
starting from 32dB
acoustic insulation
rating

Suitable for:

- office entrances
- meeting rooms
- doors for homes

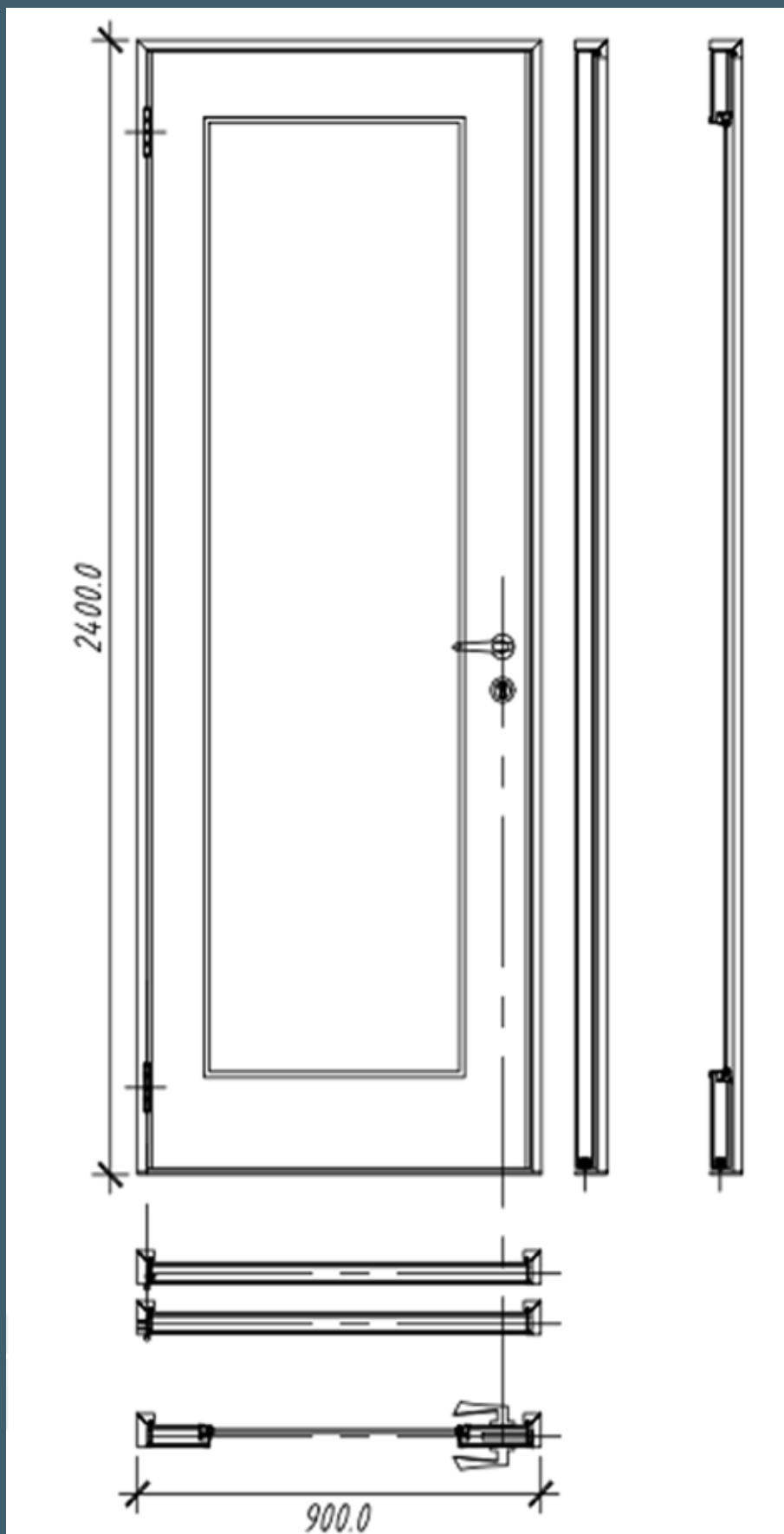

close-up of the door handle set



***Finishes available
(2100mm or 2400mm high):***

- White Melamine
- finish prepared for painting by others
- Veneers - sealed with waterbase PU sealer or stained to match



TEL: +27 11 451 8400

FAX: +27 11 609 8097

mailbox@aluglass.co.za

www.aluglass.co.za

aluglass[®]
bautech



VARIKUST[®] VK59 FIRE

THE MOST COST EFFECTIVE
ACOUSTIC **FIRE** HOTEL ROOM DOOR

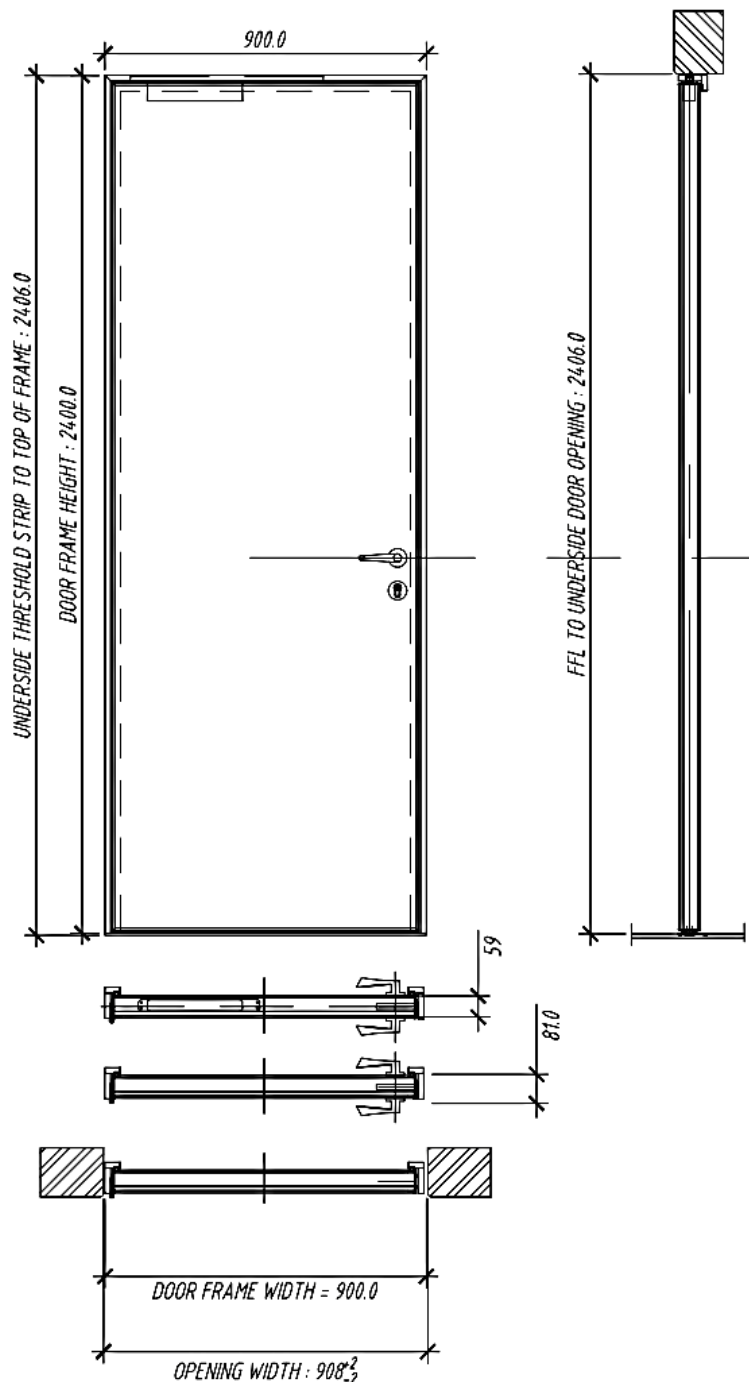

VK59F summary:

59mm thick acoustic
single FIRE door

Door max size:
900mm wide x
2400mm high

38dB acoustic
insulation rating

Available in
Class E (30min) &
Class A (60min)



GEZE BOXER EN 2-4

VK59F allows fitting of integrated door closer

Finishes available (2100mm or 2400mm high):

- Melamine
- Veneers - sealed with waterbase PU sealer or stained to match

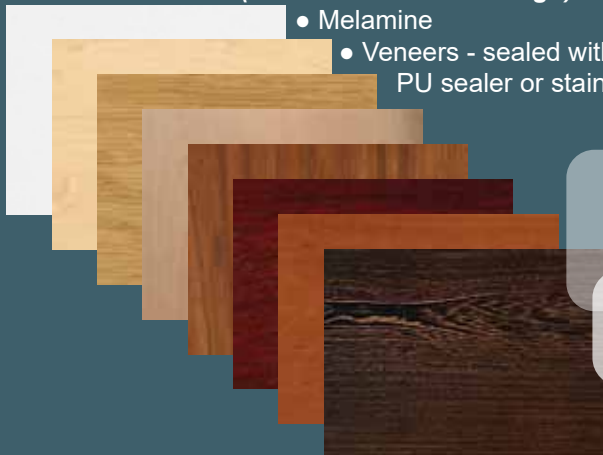

Class E success!



Please note: the initial small-scale tests are successful and full-scale tests are imminent shortly.

SPECIFICATION TEXTS AVAILABLE ON AUTOSPEC AND OUR WEBSITE



TEL: +27 11 451 8400

FAX: +27 11 609 8097

mailbox@aluglass.co.za

www.aluglass.co.za

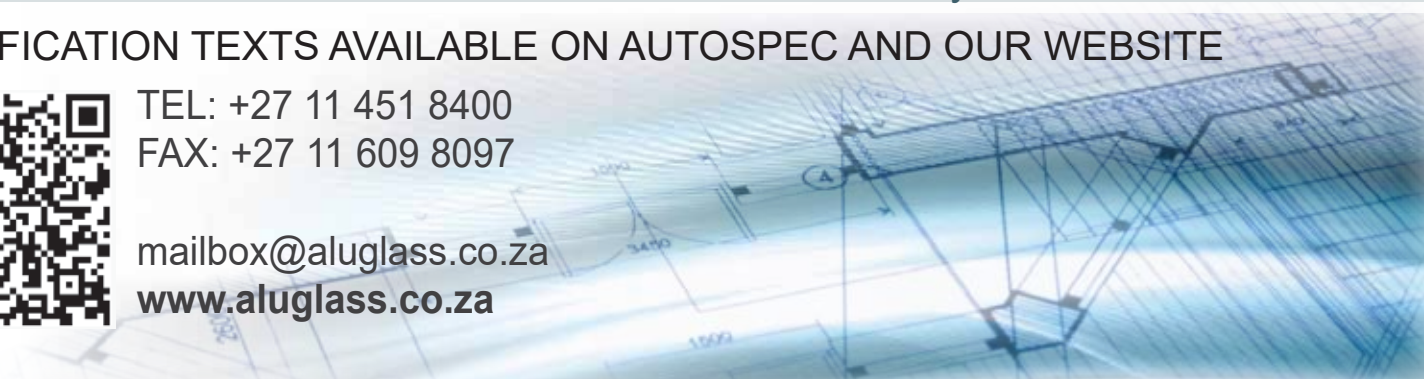

aluglass[®]
bautech

VARIKUST[®] VK62 FIRE



ACOUSTIC FIRE DOORS

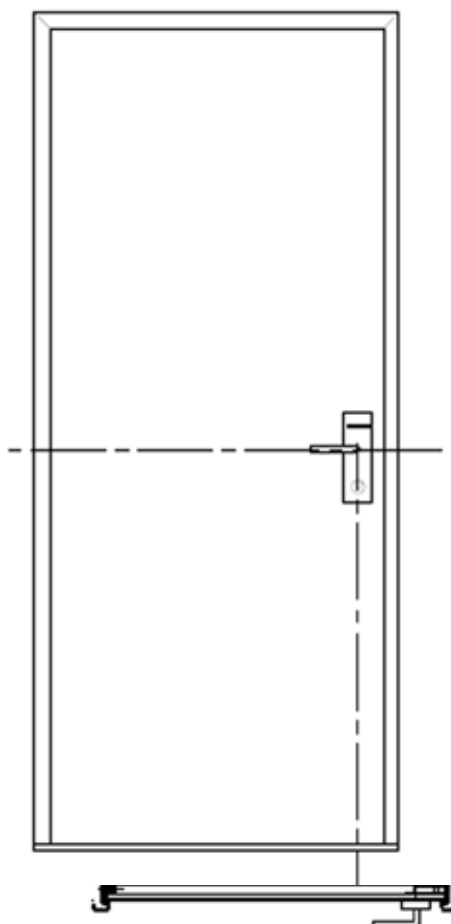

FIRE TEST RESULTS - ACCORDING TO SANS 1253. SANS 10177 - 2 (FRR)

FIRE RESISTANCE RATING (FRR): 60min

INTEGRITY : criteria satisfied for a period of approximately 1hr 14minutes

STABILITY : criteria satisfied for a period of approximately 1hr 15minutes

INSULATION : the maximum single temperature reached before the test was terminated at 1hr 15minutes was 80.2°C and the maximum average temperature at the time was 71.1°C

This door exceeds the requirements for INTEGRITY, STABILITY & INSULATION for a **CLASS A FIRE DOOR** (test report available on our website).

SOUND TEST RESULTS

**STANDARDISED LEVEL DIFFERENCE ACCORDING TO ISO 162283-1 2014
FIELD MEASUREMENTS OF AIRBORNE SOUND INSULATION BETWEEN ROOMS**

Frequency	DnT
Hz	dB
50	27.4
63	29.5
80	30.1
100	26.7
125	25.8
160	31.5
200	30.5
250	31.2
315	33.7
400	36.7
500	39.3
630	41.2
800	42.1
1000	41.4
1250	44.2
1600	44.2
2000	45.7
2500	46.1
3150	47.9
4000	49.8
5000	50.7

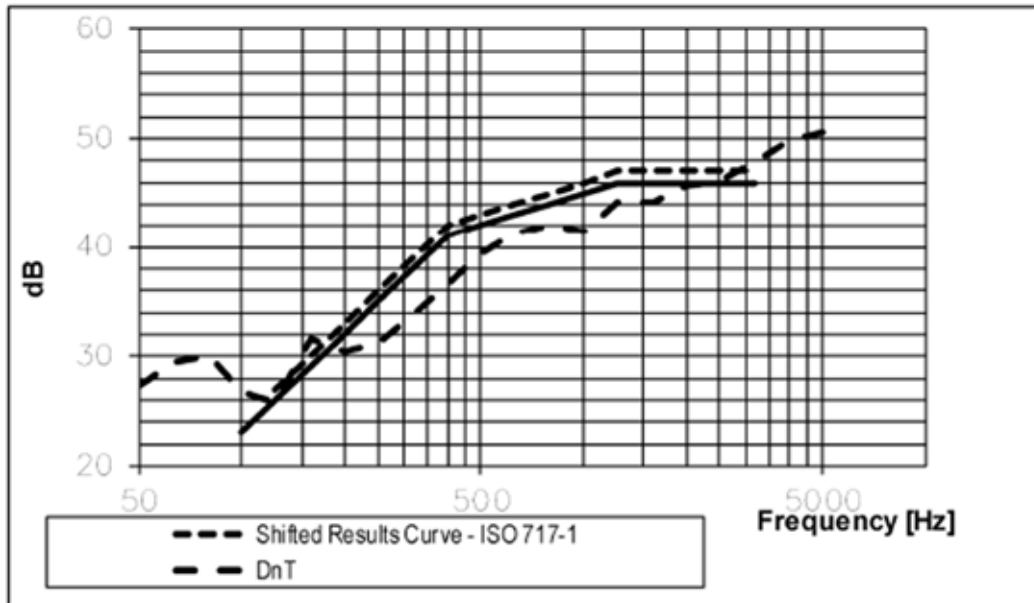

RATING ACCORDING TO ISO 717-1

DnT _{ra} (C; Ctr) =	42	(-1;-5) dB
DnT _w (C; Ctr, C ₅₀₋₅₀₀₀ ; Ctr ₅₀₋₅₀₀₀) =	42	(-1;-5 -1;-5) dB
STC RATING ACCORDING TO ASTM - E413	43	dB

4mm door skin finishes

- Superwhite
- MDF - can be painted by others
- Veneers - sealed with waterbase PU sealer or stained to match
- HPL - formica, fenix, merino
- Specialised facing e.g. Nanotech
-other finishes on request



Frame finishes

- mild steel plate
(primed for painting by others)
- SS430 plate - stainless steel
(primed for painting by others)
- > additional decorative frame finish:
timber architrave - from solid timber
(for hinge side and / or push side)

Door locks

The VK62 acoustic fire door is prepared for a lock to specifications, and is compatible with access control hardware with a backset ≥ 70 mm e.g. ASSA ABLOY VINGCARD Classic Euroline 80BS

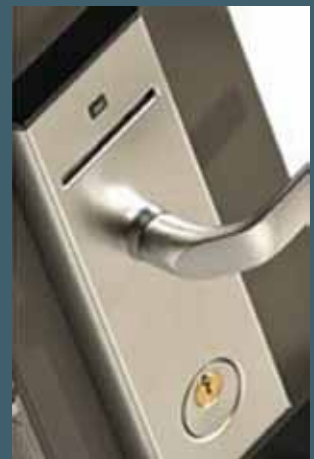

SPECIFICATION TEXTS AVAILABLE ON AUTOSPEC AND OUR WEBSITE



TEL: +27 11 451 8400

FAX: +27 11 609 8097

mailbox@aluglass.co.za

www.aluglass.co.za

ABSORPTION PANELS

slotted wood veneer panels

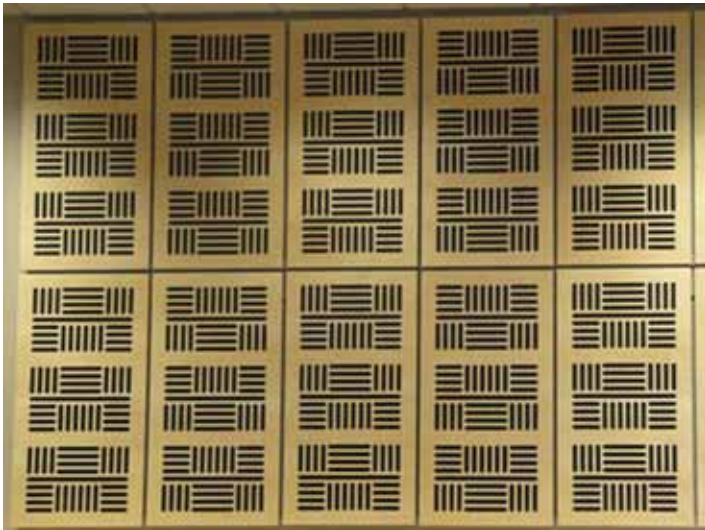

- reduces unwanted reflections and echos •
- used in auditoria, listening rooms, home theaters, theaters •
- noise reduction coefficient (NRC's) range from 0.5 to 0.85 •
 - compliments our range of acoustic products •
 - acoustic panels fitted to either walls or ceilings •





natural wood veneer finishes include
crown mahogany veneer
maple veneer
cherrywood veneer
beech veneer
white oak veneer
rosewood veneer

- can be intergrated into Aluglass Bautech Variflex® system •



SPECIFICATION TEXTS AVAILABLE ON AUTOSPEC AND OUR WEBSITE



TEL: +27 11 451 8400

FAX: +27 11 609 8097

mailbox@aluglass.co.za

www.aluglass.co.za



FABRICMATE
SYSTEMS

Wall Finishing Solutions

acoustics | functionality | aesthetics | durability



Aluglass Bautech would like to introduce Fabricmate Systems to southern Africa! A global supplier of environmentally friendly and cost effective acoustic panels, fabric upholstered wall products, fabric wrapped panels, amongst other products. Fabricmate is recognized worldwide as a “solutions company” with products engineered and designed to enhance working, learning and living environments. Fabricmate products address some of the key interior environment issues such as acoustical surfaces, privacy, speech intelligibility, sound reverberation, general noise reduction and reducing overall wall maintenance cost. These **QUICK & EASY** to install panels are customised to fit any room size and will compliment your decor and design.



Absorption panel applications for:

- Conference rooms
- Meeting & board rooms
- Audio, command & control centres
- Offices
- Home Theatres
- Classrooms – schools & universities
- Libraries
- Hospitality facilities
- Restaurants
- Hallways & corridors
- Gyms & multi-purpose rooms
- Lobbies & reception rooms
- Auditorium & theatres
- Places of worship

Available panel tracks:

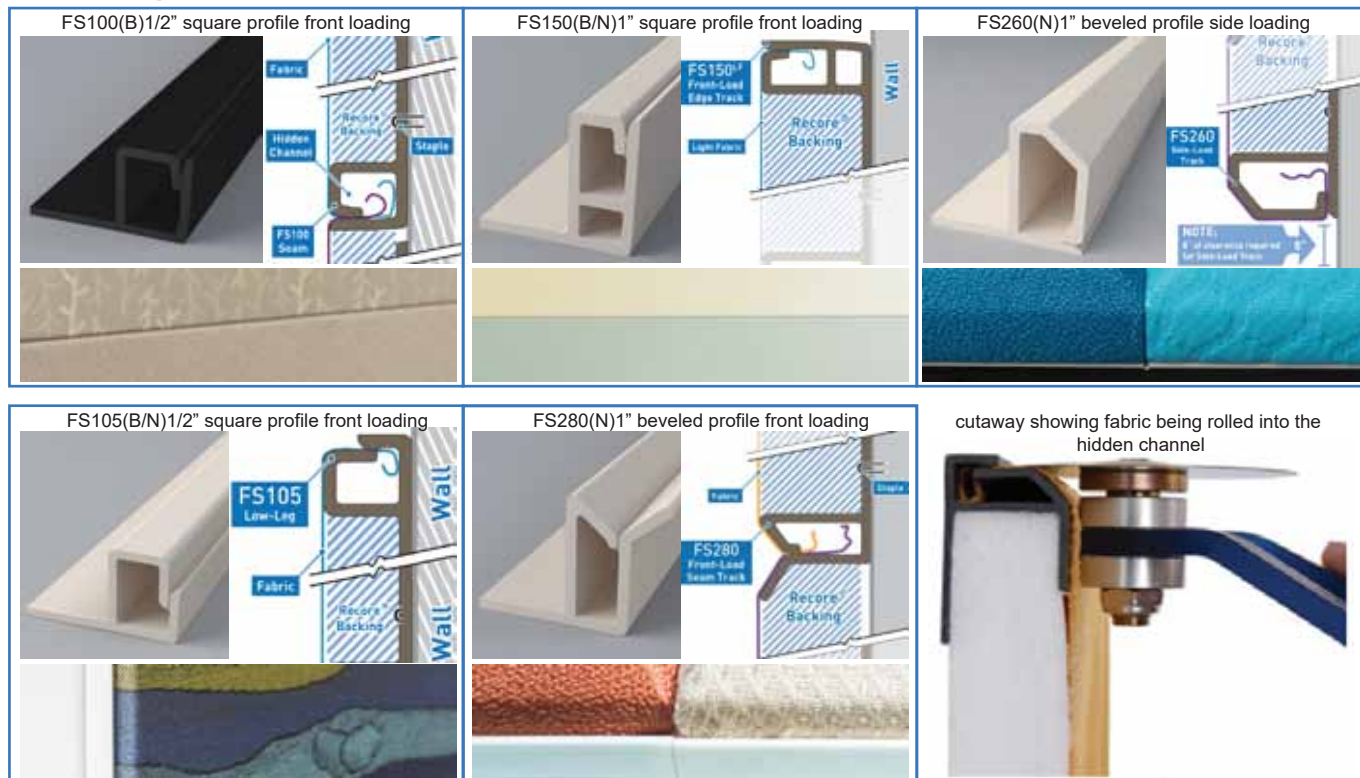

Available extrusions colours: BLACK(B)



NEUTRAL(N)



All technical information is taken from www.fabricmate.com/

Fabric to be used:

Aluglass Bautech offers a wide range of Vulcan fabrics - **PLEASE CONTACT US TO VIEW THE FULL RANGE**. Customers may also supply upholstery grade fabric to suit decor and interior. Please make sure if your fabric is "directional" that it is not turned from vertical to horizontal (or vice versa) when using cutoffs or smaller sized panels. Similarly, pay attention to any "pattern" (or "repeat") the fabric may have. There are fabrics that both have patterns and are directional.



SPECIFICATION TEXTS AVAILABLE ON AUTOSPEC AND OUR WEBSITE



TEL: +27 11 451 8400

FAX: +27 11 609 8097

mailbox@aluglass.co.za

www.aluglass.co.za



new innovative design

GF SERENE

re-mountable & re-locatable acoustic partitioning



The ideal acoustic re-mountable partition system to create **quiet office spaces** within open plan applications.

Quick and easy to install, remove and re-install with modular glass elements and flexible frame components.



The GF Serene Range integrates directly with the Aluglass Bautech Varikust® VK62 acoustic doors.

3 options are available: GF Serene 35 - 35dB

GF Serene 45 - 45dB

GF Serene 50 - 47dB

In ceiling and floor space insulation treatments available. Decorative treatments such as sandblasting and decal applications of or on the glass are possible.

The system also integrates seamlessly with our Varikust® VK62 acoustic doors and Variflex® VX83 mobile acoustic partitions with matching acoustic specifications to further enhance the integrity and flexibility of the quiet spaces created.

180 deg glass to glass joints are dry joined with a transparent VHB joining tape (not wet siliconed). The system can accommodate clear heights (floor to u/s ceiling) of up to 3.6m with the door height maximum being 2.6m. Single (clear width up to 900mm) and double doors (clear width up to 1600mm) with or without retractable threshold seals available.



SPECIFICATION TEXTS AVAILABLE ON AUTOSPEC AND OUR WEBSITE



TEL: +27 11 451 8400

FAX: +27 11 609 8097

mailbox@aluglass.co.za

www.aluglass.co.za



SUNFLEX

Frameless Glass Sliding & Frameless Stacking Doors



The living spaces of human beings have always consisted of eclectic living concepts. This calls for individual solutions. SUNFLEX Frameless Glass Sliding and Frameless Stacking Doors products offers the most diverse possibilities to create maximum living spaces and to enhance their usefulness significantly. The SUNFLEX systems are being used in many areas of daily life, for example as Glazed Folding Doors, Terrace and Conservatory Glazing, Balcony and Facade Glazing, Store Entrances, Room Dividers and Dividing Walls for home and office.

SF25 – frameless stacking doors

- Minimum impact on existing architecture
- Timeless design with no visible sightlines
- Offers weather protection from the elements
- Slim construction ensures maximum opening space with smallest stacking area
- Internal drainage channel track to remove any condensation or flush track option
- Low maintenance and fully guaranteed



Straight Systems

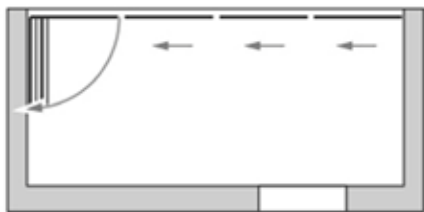

Segmented Systems

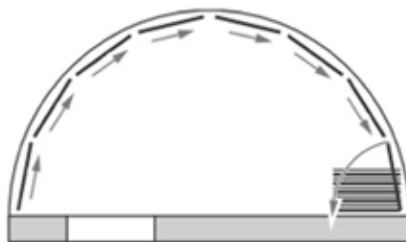

Angle Solutions 90°-180°



SF20 – frameless sliding doors

- Minimalist designed sliding doors with no visible sight lines
- Energy-saving that also offers weather protection from the elements
- Wide variety of configurations
- Automatic opening and closing of slave panels when main sliding panel is operated
- Internal track drainage for cleaning and anti-slip floor track or flush track option
- Low maintenance and fully guaranteed

- Aluminum extrusions are available in standard powder coating colours as per RAL ●
 - Glazing with toughened safety glass panel structure of 8 or 10 mm ●
(to be specified per application and size)
 - Heights up to 2800mm, depending on wind load and panel widths ●
 - Both systems for internal and external applications ●
- For more information, technical data or drawing details, please visit our website ●

SPECIFICATION TEXT AVAILABLE ON OUR WEBSITE



TEL: +27 11 451 8400

FAX: +27 11 609 8097

mailbox@aluglass.co.za

www.aluglass.co.za



SOLAMARK[®]

retractable and fixed sun control fabric awnings



*Also available in
an external
semi-transparent
fabric for a view to
the outside*

Aluglass Bautech offers a wide range of Awning fabrics - PLEASE CONTACT US TO VIEW THE FULL RANGE. Below are some examples.



5005 Flanelle



5093 Chalk

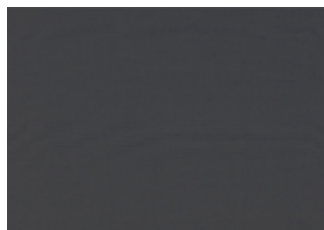

5042 Charcoal tweed



5048 Hemp



F048 Infinity



5372 Vibration



5127 Desert



F035 Silence

SOLAMARK® AWNING RANGE EXAMPLES

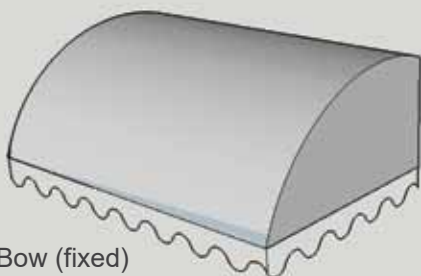

Bow (fixed)

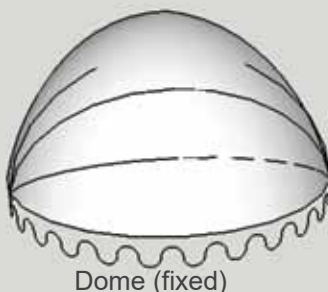

Dome (fixed)

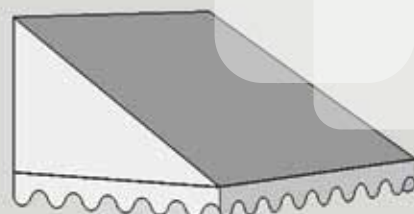

Wedge (fixed)

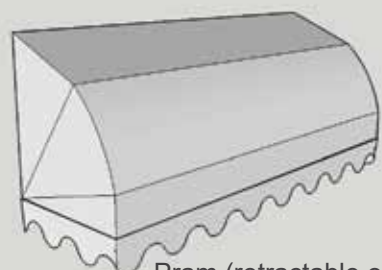

Pram (retractable or fixed)

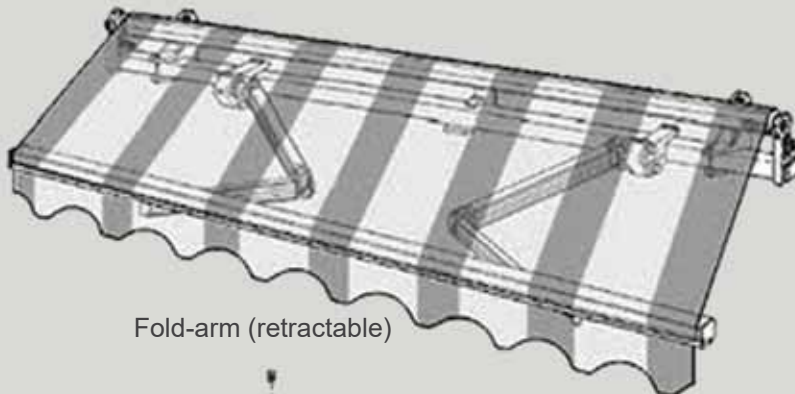

Fold-arm (retractable)



Drop-arm (retractable)

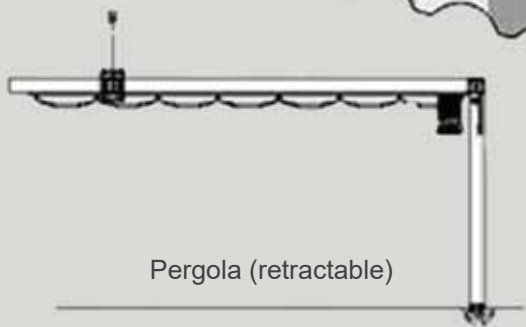

Pergola (retractable)

SPECIFICATION TEXTS AVAILABLE ON AUTOSPEC AND OUR WEBSITE



TEL: +27 11 451 8400

FAX: +27 11 609 8097

mailbox@aluglass.co.za

www.aluglass.co.za

SOLUX[®]

TECHNICAL SUN CONTROL SOLUTIONS



- Internal or external application
- Material and hardware imported from Europe, Asia and Australia
- Metallised and non-metallised roller fabric available
- Operational systems include manual, motorised or remote control options
- Advanced time regulation or sun sensor systems available
- Blind operation can be integrated into the building management system using SMI (standard motor interface) motors and KNX control automation



Applications include:

- Offices
- Glass Facades
- Training Facilities
- Restaurants
- Shop fronts
- Hotels
- Conservatories
- Atriums
- Homes

SPECIFICATION TEXTS AVAILABLE ON AUTOSPEC AND OUR WEBSITE



TEL: +27 11 451 8400

FAX: +27 11 609 8097

mailbox@aluglass.co.za

www.aluglass.co.za

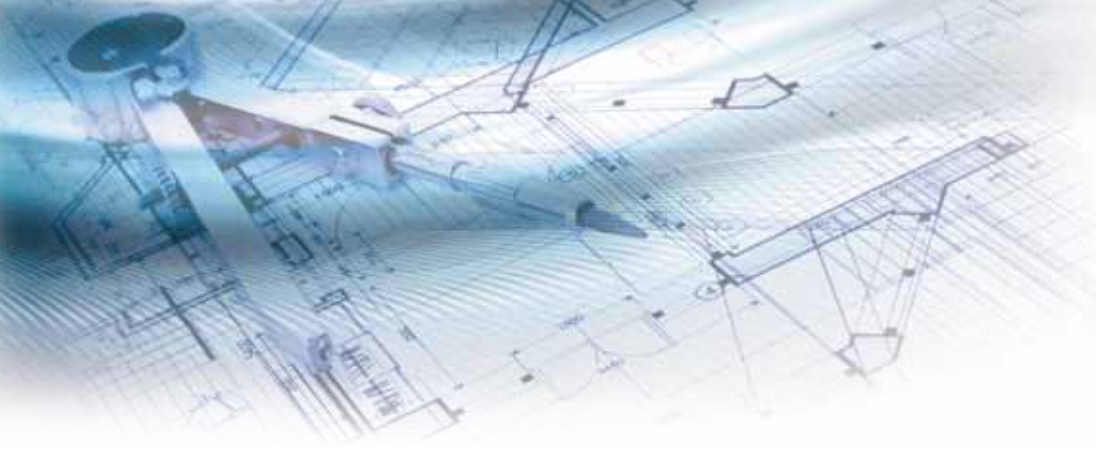

SHOWERFLEX[®]

frameless & framed shower and bath enclosures





SPECIFICATION TEXTS AVAILABLE ON AUTOSPEC AND OUR WEBSITE



TEL: +27 11 451 8400

FAX: +27 11 609 8097

mailbox@aluglass.co.za

www.aluglass.co.za

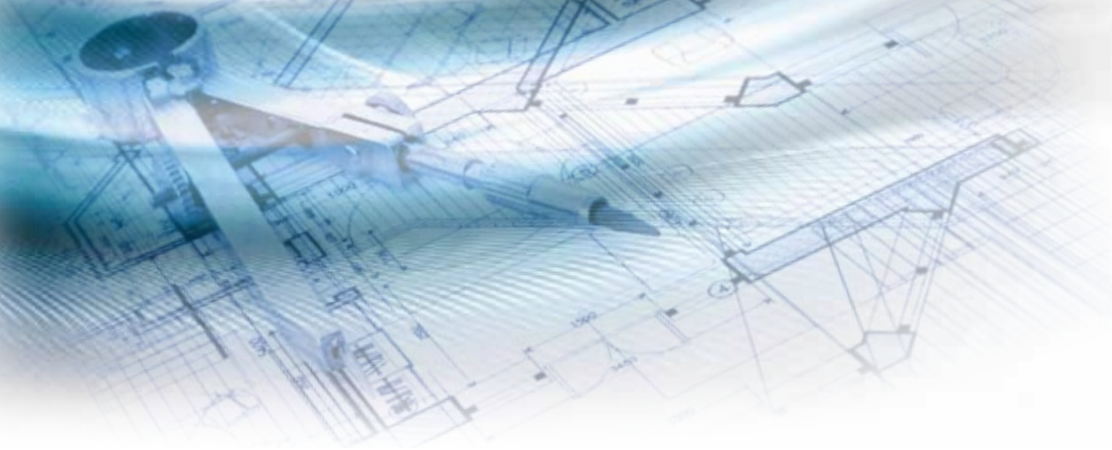

VARIFOLD[®]

custom made single / double wooden folding doors





Varifold® *wooden folding doors* are available in the following finishes:

- white melawood
- crown mahogany veneer
- maple veneer
- cherrywood veneer
- beech veneer
- rosewood veneer
- walnut veneer
- etimoe veneer
- imbuia veneer
- oak veneer

NOTE: Owing to the processes of nature, colour samples may differ considerably from the original. We therefore recommend seeing the different samples before making a final decision.

Aluglass Bautech uses an environmentally friendly water base lacquer.



SPECIFICATION TEXTS AVAILABLE ON AUTOSPEC AND OUR WEBSITE



TEL: +27 11 451 8400

FAX: +27 11 609 8097

mailbox@aluglass.co.za

www.aluglass.co.za

GLASS BRICKS

International project ideas using Glass Bricks



South African project ideas using Glass Bricks



Glass bricks examples (for the full range please visit our website product page)



Flemish 198 & 248



Clearview 198 & 248



Crossribbed 198



Savona 198

SPECIFICATION TEXTS AVAILABLE ON OUR WEBSITE



TEL: +27 11 451 8400
FAX: +27 11 609 8097

mailbox@aluglass.co.za
www.aluglass.co.za