

System 55[®] Roller Blinds

Our System 55[®] roller blinds are manufactured using the Louvolite System 55[®] roller blind mechanism with specifically designed grooved 55mm honeycomb aluminium tubing. The specified fabrics are formed and held into the tube with locking tape ensuring reliable performance and improved chain location enables quick and easy onsite adjustment.

Size constraints:

Max Width:	4000mm
Max Drop:	4500mm
Max Weight:	11.5kg

Brackets:

The mild steel brackets are zinc plated and powder coated, suitable for top, face or side fixing.

Performance:

To ensure a positive performance, all Louvolite Roller System units are designed and manufactured in the UK using prime quality plastic materials and a dedicated steel locking spring. The chain control will lock into the bracket with the unique bracket securing pin for safety after installation. 10-year life cycle testing is done to ensure long lasting performance. The units will accept both metal or plastic operating chain providing reliable smooth operation.

Operation:

Can be motorised, or chain control.

The chain control units, manufactured in the UK, are made from glass filled Nylon 6, with an acetal sprocket and sprocket guard. The operating chain, No. 10 size in metal or plastic. A sprung plunger end mechanism is positioned at the opposite end to the control unit, providing a more secure fit of the blind and smooth operation.

Bottom Bar

Oval Anodised:

An anodised aluminium extrusion, which is attached to the fabric using 7mm locking tape and is left exposed (not covered by fabric)

Teardrop:

An aluminium or PVC extrusion, which is attached to the fabric using 7mm locking tape and wrapped over the front of the bottom bar leaving the back exposed.

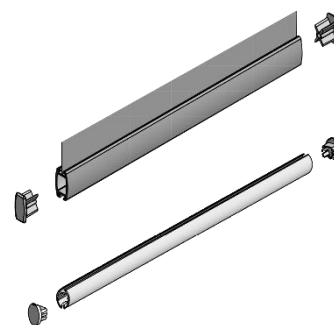
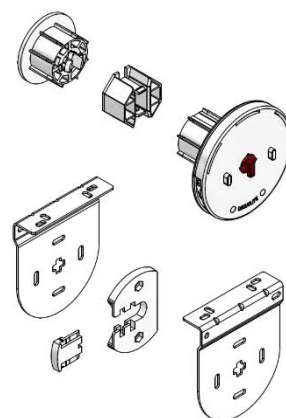
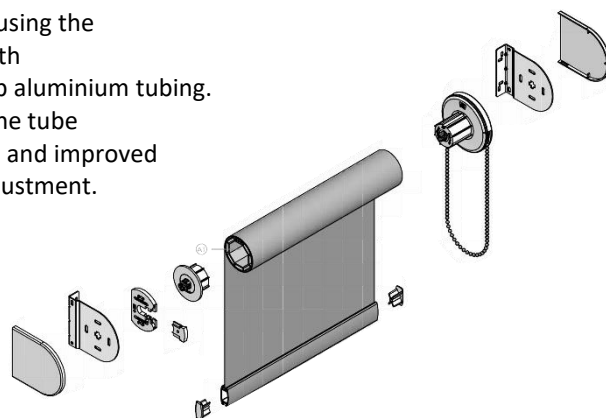

Additional Options:

Closed Cassette:

Only available for motorised blinds on system 55. Aluminium Extrusion designed and powder coated with dedicated top, direct or face fix brackets. The closed cassette is usually used in conjunction with side and bottom channels to create a blackout system.

Side channels:

Aluminium Extrusion designed and powder coated. The extrusion has channels to accommodate angled brushes to block light from escaping around the fabric.

Wire guide system:

The guide wire includes dedicated brackets, a PVC coated wire and glass filled Nylon plastic base or side fixing units designed to guide a specialised bottom bar end cap.

Easi Lift™ Spring:

The Easi Lift™ spring is a spring which becomes tensioned as you drop the blind, and assists in lifting the blind by de-tensioning allowing you to operate larger blinds with a chain control. The Easi Lift™ system is suggested for blinds over 4.5kg to give optimum performance.

Bracket dimensions:

SYSTEM 55® BRACKET DIMENSIONS

Uses System 45®+ brackets and System 45® extension brackets

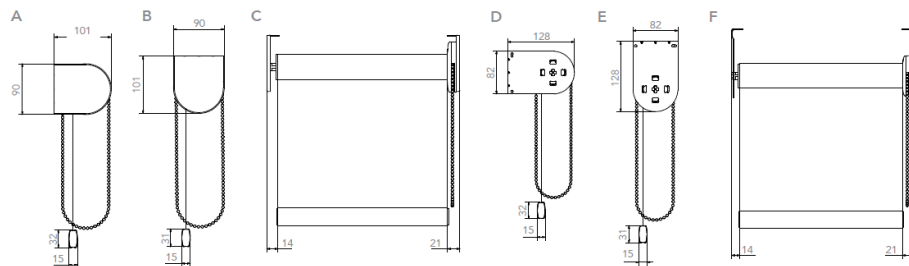

- A. 45®+ standard metal bracket face fix & cover
- B. 45®+ standard metal bracket top fix & cover
- C. 45®+ standard metal bracket top fix front view
- D. 45® extension bracket face fix
- E. 45® extension bracket top fix
- F. 45® extension bracket top fix front view