

ILLUSTRATIONS

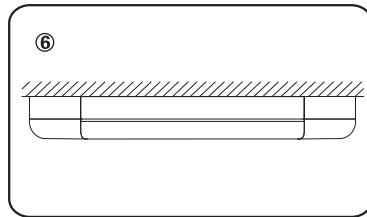

eurolux
Lighting your way

Closed Channel Fluorescent Ceiling Light

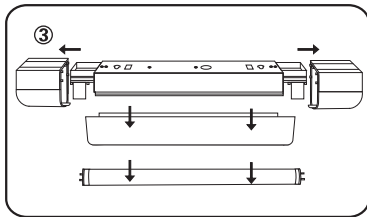
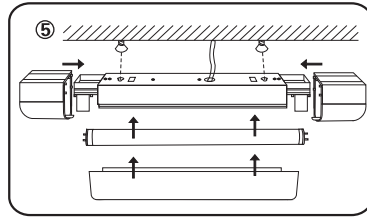
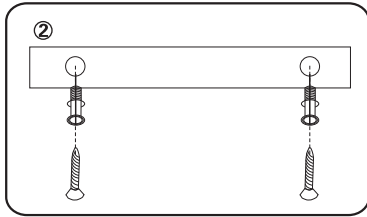
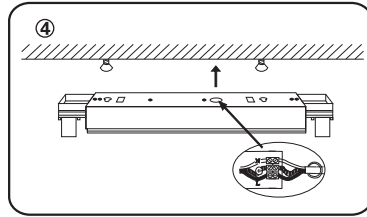
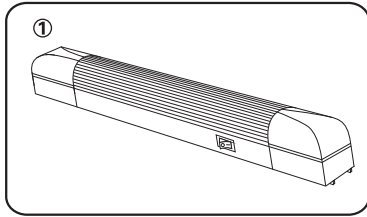

Including 1 x G13 maximum 18W T8 Fluorescent Tube 230V

PRODUCT CODE

C11W

ENVIRONMENTAL PROTECTION



Waste electrical & Electronic equipment regulations requires that any of our products showing this marking must not be disposed of with other household or commercial waste. To prevent possible harm to the environment or human health from uncontrolled waste disposal, please separate any such products from other waste types and recycle it responsibly at your local facilities.

Cape Town - 9 Racecourse Road, Milnerton, 7441
Johannesburg - 10 Milkyway Avenue, Linbro Business Park, Sandton, 2065
www.eurolux.co.za

Please read instructions before commencing installation and retain for future reference.

SPECIFICATIONS

- **Fitting material:** Plastic body with diffused plastic.
- **Lamp type:** Including 1 x G13 maximum 18W T8 Fluorescent Tube 230V.
- **Voltage:** 220V - 240V ~ 50Hz.
- **Protection against electric shock:** Class 1. Requires earthing connection.
- **IP Rating:** 20. Protected against solid foreign objects of 1.0mm Ø and greater.
- Commercial use / Domestic use.
- **Maximum ambient temperature range:** 20°C - 40°C.
- Can be used in coastal areas and other corrosive environments.
- **Dimensions:** (L)645mm x (W)35mm x (D)65mm.
- **Additional information:**
 - Undercounter
 - Electronic Control Gear
 - Mounted Switch

IMPORTANT SAFEGUARDS

C11W - attachments:

If the external flexible cable or cord of this luminaire is damaged, it should be exclusively replaced by the manufacturer or his service agent or a similar qualified person in order to avoid a hazard. To ensure that you get maximum longevity and maximum use out of your luminaire, please observe the following safety instructions.



Electrical products can cause death, injury, or damage to property. Installation of the luminaire must be carried out by a qualified electrician, in accordance with SANS 10142. On completion of installation, ensure that the Certificate of Compliance is updated.

- Before connecting this luminaire, ensure that voltage indicated on the rating label corresponds with the mains voltage in your home.
- When changing the lamp, ensure that the power is turned off.
- This luminaire is checked in full for conformity to the quality standards and safety requirements.
- The manufacturer / supplier is not responsible for any damage of properties and persons, caused by the incorrect use or installation of the luminaire.
- Should you be unsure of how to install this luminaire correctly, please consult a qualified electrician or your supplier for assistance.
- Ensure all items / components, threads and screws are tightly secured.

IMPORTANT:

- Tampering with this luminaire, i.e. using silicon sealers or incorrect cabling, will invalidate your warranty.
- When the protection glass is damaged, it should be replaced immediately.
- Please check whether the connection of the power cord is safe and reliable before installation.
- Always ensure that the mains supply voltage is correct.
- Always replace the lamp with one of an identical rating.
- Ensure that you do not place the luminaire near any combustible materials and / or surfaces.
- Choking hazard: May contain small parts. Keep away from children.
- Do not insert your fingers or any part of your body into the electrical contact and sockets of this product whilst it is connected to the electricity supply.
- Item may vary slightly from the picture on the carton.

INSTALLATION

- Before installation always ensure the power supply is turned off.
- This luminaire is only suitable for fixed mounting.
- Not for use outdoors or in areas exposed to moisture.
- Insert masonry plugs into the mounting surface. Test to ensure the mounting surface will hold the weight of the fitting.
- Connect main supply into terminal block making sure all connections are tight.
- Fit ceiling plate onto mounting surface with self-tapping screws.
- Fit lamp firmly into lamp holder.
- Make sure all connections are tight.
- Once all are installed.
- Reconnect power supply.

CLEANING

- Before cleaning always ensure the power supply is turned off.
- Do not immerse the luminaire in water.
- No abrasive products, solvents, detergent may be used to clean this luminaire.
- Ensure that the fitting does not come in contact with corrosive chemicals, etc.
- Coastal areas ensure that the luminaire is cleaned fortnightly.