



LYRA CONCEALED DIVERTER MIXER

034148

SPECIFICATION SHEET

PRODUCT DETAILS

CARTRIDGE HIGH QUALITY SUPERIOR SPEC CARTRIDGE
INCLUDES DIVERTER TO DIVERT WATER TO AN ADDITION-
AL OUTLET

TECHNICAL SPECIFICATIONS

FLOW RATE 21L & 17L / MINUTE THROUGH THE DIVERTER @
300Kpa

SABS APPROVED*

BRASS GRADE DZR (dezincification resistant brass) Cz132

CHROME PLATING 200 HOUR SALT SPRAYED FINISH (Ni: 7μ
& Cr: 0.2μ) THICKNESS

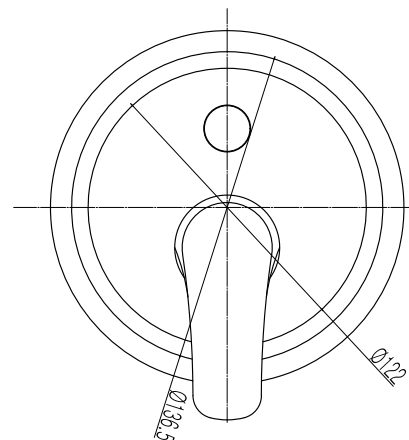
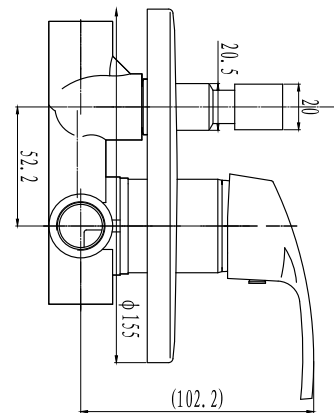

CLEANING INSTRUCTIONS

1. Avoid cleaning agents containing ingredients, such as chlorine bleach, formic acid, acetic or Hydrochloric acid.
2. Wipe all surfaces using a soft unabrasive cloth, with warm soapy water.



5 YEAR WARRANTY

WWW.PLUMBLINK.CO.ZA

Plumblink tries its best to ensure that the information given on our website is accurate. Although, we cannot guarantee this for certain, and accept no liability for any information.