



CRUX BASIN MIXER

035568

SPECIFICATION SHEET

PRODUCT DETAILS

CARTRIDGE SEDAL ANTI-SCALD CARTRIDGE (TEMPERATURE CONTROL)

NEOPERL AERATOR EASY FLOW AERATOR

FIXATION SET TUBULAR FIXATION WITH NYLON NUT, WITH BRASS THREADS. COMPATIBLE BRASS TUBE FOR EASY INSTALLATION.

450mm BRAIDED CONNECTORS EXTENDED MIXER BRAIDS WITH OFFSET HEX'S FOR EASIER TIGHTENING & FOR AN EASIER INSTALLATION .

EXTENDED COPPER TUBES COPPER INTERNAL TUBES ALLOW FOR EASY BRAID INSTALLATION.

TECHNICAL SPECIFICATIONS

FLOW RATE 7.4L/ MINUTE @ 300Kpa

SABS APPROVED*

BRASS GRADE DZR (dezincification resistant brass) Cz132

CHROME PLATING 200 HOUR SALT SPRAYED FINISH (Ni: 7μ & Cr: 0.2μ) THICKNESS

QUIET FLOW TECHNOLOGY BUILT-I NOISE SUPPRESSOR IN CARTRIDGE

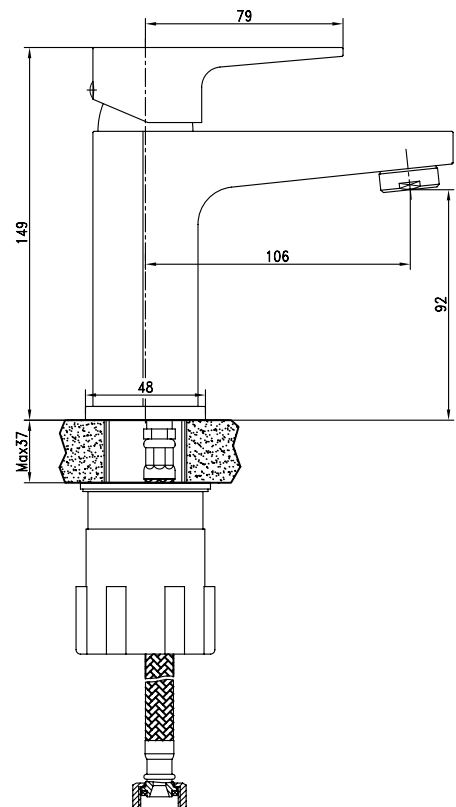

CLEANING INSTRUCTIONS

1. Avoid cleaning agents containing ingredients, such as chlorine bleach, formic acid, acetic or Hydrochloric acid.
2. Wipe all surfaces using a soft unabrasive cloth, with warm soapy water.



10 YEAR WARRANTY

WWW.PLUMBLINK.CO.ZA

Plumblink tries its best to ensure that the information given on our website is accurate. Although, we cannot guarantee this for certain, and accept no liability for any information.