

EPOXY MORTAR & COVING GROUTING COMPOUND

**QUICK STRENGTH DEVELOPMENT
VERSATILE SITE GROUTING COMPOUND
RESISTS VIBRATION
LOW TOXICITY
WATER WASHABLE**

PRINCIPAL USES

For bearing pads, under machine bases, floor/wall patching and honeycomb repairs. Also used as tile jointing compound and cove skirtings in commercial kitchens, hospitals, etc.

RESISTANCE

Resists most common aggressive chemicals, aliphatic solvents and petroleum products.

TYPICAL MECHANICAL PROPERTIES

Compressive Strength 90-100 MPa

Refer to aggregate/resin ratio loading information on graph.

SPECIFICATION

Apply Pro-Struct 618/22 Mortar Grouting Compound in accordance with manufacturers detailed instruction. In tile joints the width and depth is to exceed 6mm.

PACKAGING

Pro-Struct 618R: Base + Activator = 1lt
Graded Aggregate # 622 = 6kg

INSTRUCTIONS

Prior to application, the surface must be clean, dry and sound and surfaces should be prepared in accordance with method 1 or 3 of surface preparation specification and primed with Pro-Struct 618 Resin. Pro-Struct 618/22 is supplied as a 3-pack kit. The contents of the two tins must be mixed thoroughly by pouring the smaller into the larger tin and stirring for 4 to 5 minutes. The aggregate should be mixed so that no particle size separation is apparent and then blended with the premixed liquid. After mixing, use material within 60 minutes. Should less than the complete kit be used, two parts by volume of the base should be mixed with one part by volume of the activator. Clean equipment immediately after use with Pro-Struct 105 Brush Cleaner and rinse off in clean water.

CAUTION

Under no circumstances should Pro-Struct 105 Brush Cleaner be mixed with any Pro-Struct Epoxy Compound as this will inhibit the curing of the material. To avoid confusion, Pro-Struct 105 Brush Cleaner is coloured **blue**. Remove spots of Pro-Struct Epoxy on hands with cotton waste dipped in water. Always wash well with soap and water after using this material.

See also Instruction Sheet "Handling of Epoxy Products"

TYPICAL PROPERTIES AT 25°C

Finish	Aggregate/Resin
Colour	Neutral
Consistency	Trowelable Mortar
Volume Solids	100%
Theoretical Coverage Per Coat	1m ² /3.64 litre kit at 3.64mm thick
No. of Components	3
Mixing Ratio	1 Litre A + B + # 622 Aggregate yields 3.64 litres
Pot Life	60 – 90 Minutes
Apply Over	Primed concrete or steel
Apply By	Pour, Trowel or pack
Curing Time	24 Hours at 25°C
Thinners	Nil
Shelf Life	12 Months
Max Service Temperature	60°C
Application Temperature Range	15°C to 35°C

APPLICATION INSTRUCTIONS

These instructions are not intended to show product recommendations for specific service. They are issued as an aid in determining correct surface preparation, mixing instructions and application procedure. It is assumed that the proper product recommendations have been made. These instructions should be followed closely to obtain the maximum service from the materials.

PRO-STRUCT 618/22 GROUTING COMPOUND

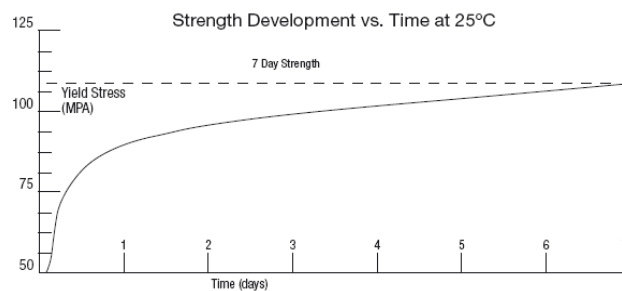
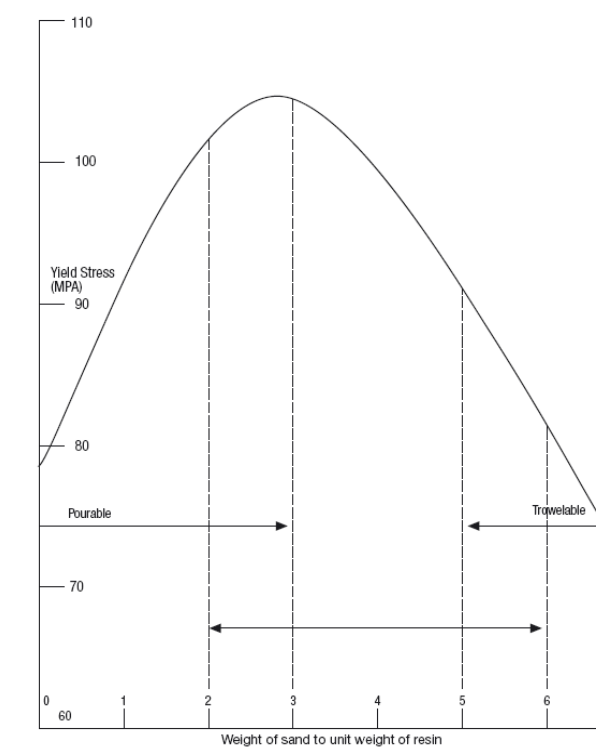

CAUTION: MAY CONTAIN FLAMMABLE SOLVENTS. KEEP AWAY FROM SPARKS AND OPEN FLAMES. IN CONFINED AREAS WORKMEN MUST WEAR FRESH AIRLINE RESPIRATORS. HYPERSENSITIVE PERSONS SHOULD WEAR GLOVES OR USE PROTECTIVE CREAM. ALL ELECTRONIC EQUIPMENT AND INSTALLATIONS SHOULD BE MADE AND GROUNDED IN ACCORDANCE WITH THE NATIONAL ELECTRICAL CODE. IN AREAS WHERE EXPLOSION HAZARDS EXIST, WORKMEN SHOULD BE REQUIRED TO USE NONFERROUS TOOLS AND TO WEAR CONDUCTIVE AND NONSPARKING SHOES



StonCor Africa (Pty) Ltd
Co. Reg. No. 1996/001848/07
Tel: +27 (0)11 254 5500
Website: www.stoncor.co.za
E-mail: stoncorsa@stoncor.com

APPLICATION INSTRUCTIONS

These instructions are not intended to show product recommendations for specific service. They are issued as an aid in determining correct surface preparation, mixing instructions and application procedure. It is assumed that the proper product recommendations have been made. These instructions should be followed closely to obtain the maximum service from the materials.

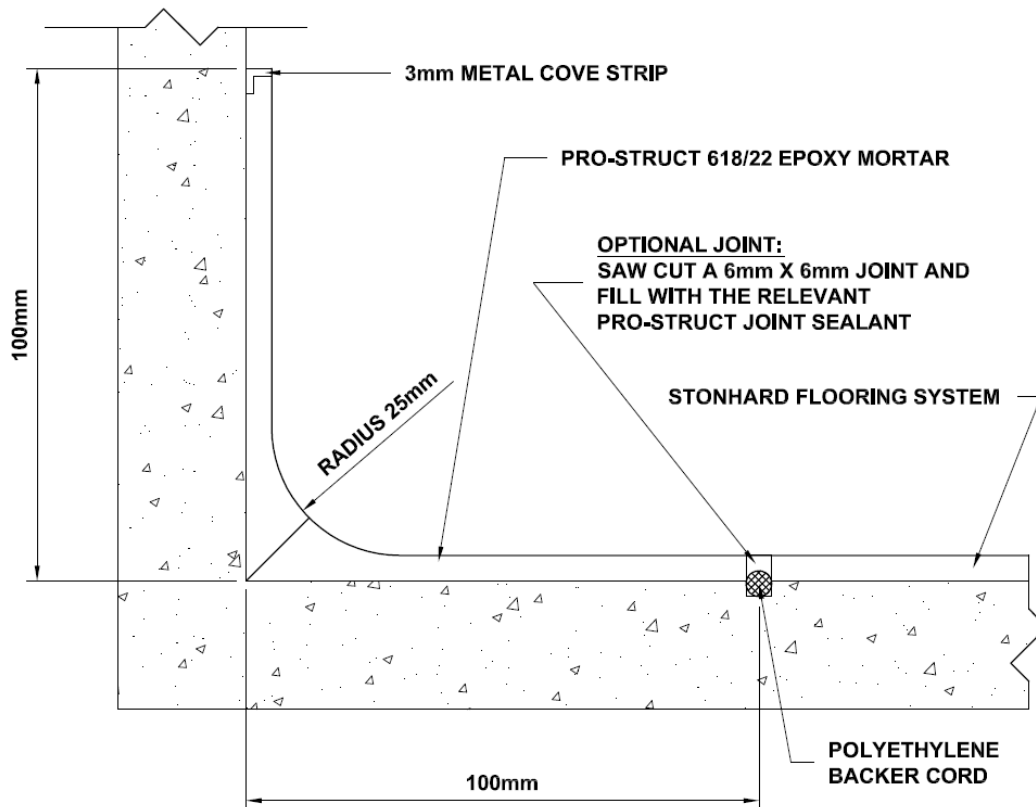

APPLICATION PROCEDURE FOR EPOXY MORTAR COVERED SKIRTINGS

- Epoxy mortar coved skirtings shall be installed prior to the installation of the flooring system.
- Install the metal cove strip to the wall to the desired height using contact adhesive, taking care to mask above the cove strip for neatness.
- Prime the prepared plastered / concrete surfaces with Pro-Struct 618R at a theoretical coverage of 15 linear metres x 200mm wide per 1 litre kit and broadcast Stonhard 6222 Aggregate into the wet resin. Allow 6 to 8 hours to cure at 25°C.
- Mix the 1 litre kits of base and activator of Pro-Struct 618/22 for 2 minutes using a JB blender. Add the 6kg bag of Pro-Struct 622 aggregate and mix for a further 2 minutes. The yield of this kit is 3,64 litres. Using a steel trowel, apply the Pro-Struct 618/22 Mortar to the primed concrete and plastered surfaces to a theoretical spreading rate of 3,6 linear metres for a 100mm x 100mm x 25mm radius.
- Form the cove to the desired radius using a suitable coving trowel, allow to cure for 18 to 24 hours at 25°C.
- Abrade the vertical surface of the cove to remove surface imperfections.
- Overcoat the coving with the proposed flooring sealer.

CAUTION: MAY CONTAIN FLAMMABLE SOLVENTS. KEEP AWAY FROM SPARKS AND OPEN FLAMES. IN CONFINED AREAS WORKMEN MUST WEAR FRESH AIRLINE RESPIRATORS. HYPERSENSITIVE PERSONS SHOULD WEAR GLOVES OR USE PROTECTIVE CREAM. ALL ELECTRONIC EQUIPMENT AND INSTALLATIONS SHOULD BE MADE AND GROUNDED IN ACCORDANCE WITH THE NATIONAL ELECTRICAL CODE. IN AREAS WHERE EXPLOSION HAZARDS EXIST, WORKMEN SHOULD BE REQUIRED TO USE NONFERROUS TOOLS AND TO WEAR CONDUCTIVE AND NONSPARKING SHOES



StonCor Africa (Pty) Ltd
Co. Reg. No. 1996/001848/07
Tel: +27 (0)11 254 5500
Website: www.stoncor.co.za
E-mail: stoncorsa@stoncor.com